

Part of Houghton Le Spring Subdivision, Waratah.  
 Sold: 6<sup>th</sup> June 1891.

Particulars taken from Litho obtained from Mr Hall.

Bearings are as used by Mr Hall.

Original Survey by R. W. Langstaff, L.S.

121° 57'

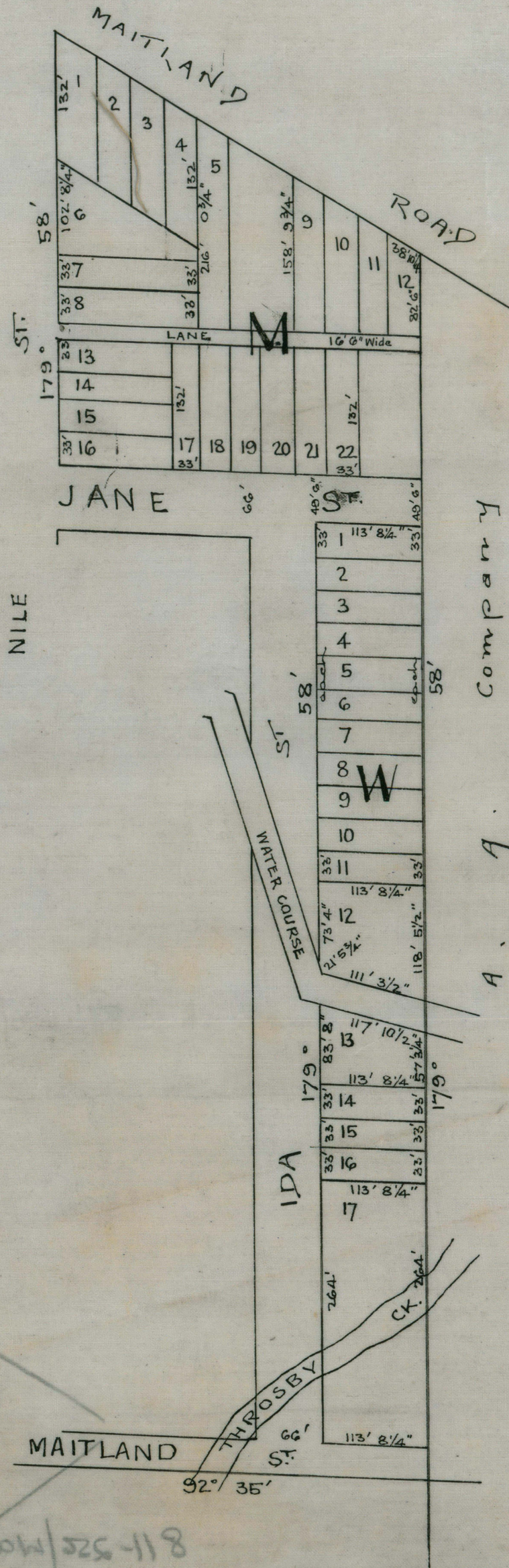

826 J  
 1891 map

811-525-118

T. 59