

Cancels part plan W.L.B. 2288 R.

Within the area withdrawn from TUPRA holding vide Gaz 26th April 1935 Offered for Lease vide Gaz. 26th April '35

Papers 35-9646

PLAN OF PORTION W.L. 1814.

County of *Kilferra*

Western Division

Applied for under Section 25 of the Western Lands Act of 1901 by Catherine Theresa Butler (Mrs)
 Western Lands Lease No 3957 vide Gazette 3.7.36
 Partly within T.S.R. 9475 Not^d 10th August 1889

Blue Hills
 East of Hills

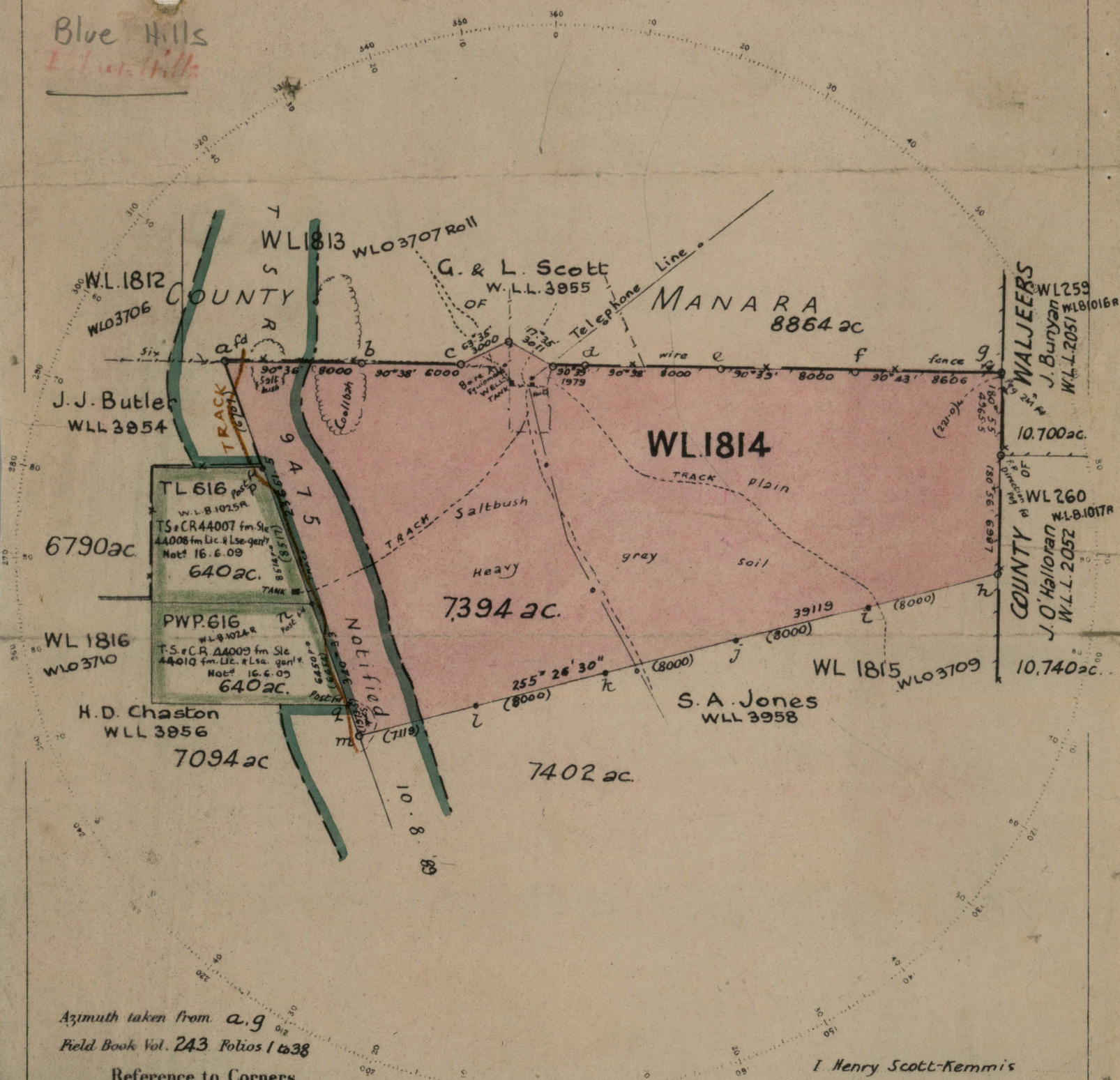

Azimuth taken from a.g
 Field Book Vol. 243 Folios 1 to 38

Reference to Corners

Corner	Bearing	From	Links	to on Tree
a	180° 33'	Ref mark	2.8	W.L. 1812-1814
b	218° 24'	Cooliboh	104.1	A
c	180° 38'	Ref mark	1.5	B
d	180° 39'	do.	2.8	C
e	180° 39'	do.	4.9	D
f	180° 41'	do.	3.0	E
g	180° 55'	do.	6.9	W.L. 1813-1814
h	255° 26'	do.	3.0	W.L. 1814-1815
i	345° 26' 30"	do.	3.0	A
j	345° 26' 30"	do.	3.0	B
k	345° 26' 30"	do.	3.0	C
l	345° 26' 30"	do.	3.0	D
m	75° 26'	do.	3.0	W.L. 1814-1815
n	160° 33'	do.	3.0	P.W.P. 616-T.L. 616
p	270° 34'	do.	3.0	W.L. 1812-T.L. 616
q	270° 34'	do.	3.0	W.L. 1816-P.W.P. 616

Ref Marks Gbl. iron pipes in all cases.

I Henry Scott-Kemmis
 of Dubbo

a Surveyor registered under the Surveyors Act, 1929 do hereby solemnly and sincerely declare that the survey, or the part thereof shown by lines represented in this plan has been made by me in accordance with the Survey Practice Regulations 1933 and the special requirements of the Western Lands Office and was completed on the 26th October 1935 Reference marks have been placed as shown on plan. I make this solemn declaration conscientiously believing the same to be true and by virtue of the provisions of the Oaths Act, 1900.

H. Scott-Kemmis
 Surveyor registered under the Surveyors Act 1929.

Subscribed and declared before me at Hillston this 9th day of November 1935

P.J. Costello J.P.
 Justice of the Peace

Transmitted to the Western Lands Commissioner, with my letter of 9-11-35 No 32

Checked and Charted J.H. Richardson 19.5.36

Examined } S.H. Pasley Draftsman
 Plan approved } 25.5.1936

Calc. Book No G. 50 Fol 20

Scale 80 Chains to an Inch

Lithographed & Printed at the Dept. of Lands, Sydney, N.S.W. 35-1327

Cat. No W.L.O. 3708

and J.P. Costello