

with s/o letter Z 378
19/10/14

with s/o Z 378
19/10/14

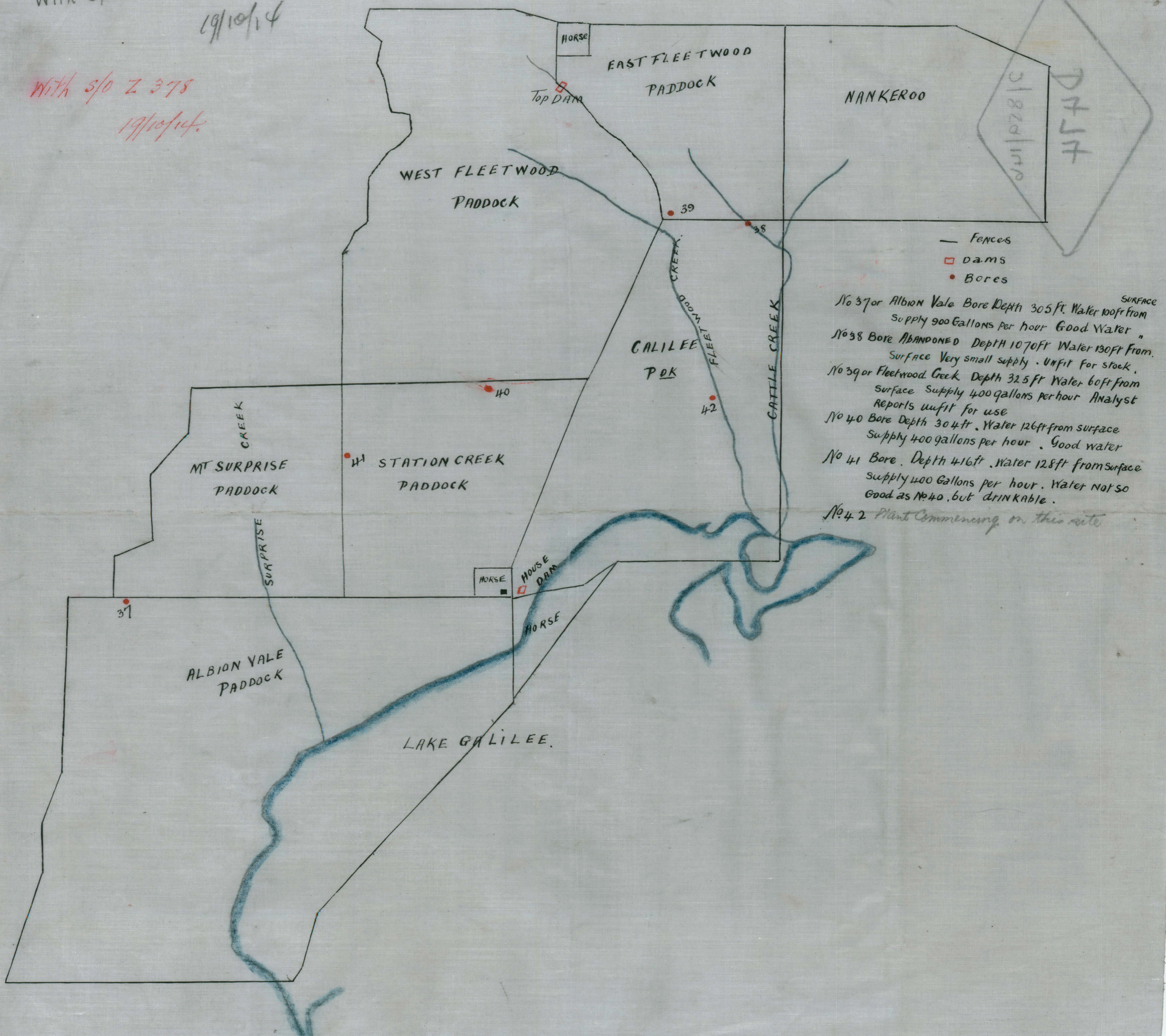

- Fences
- Dams
- Bores

No 37 or Albion Vale Bore Depth 305 ft. Water 100ft from SURFACE
Supply 900 Gallons per hour Good Water "

No 38 Bore ABANDONED Depth 1070ft Water 130ft From SURFACE
Surface Very small supply. Unfit for stock.

No 39 or Fleetwood Creek Depth 325 ft Water 60ft from SURFACE
Supply 400 gallons per hour Analyst Reports unfit for use

No 40 Bore Depth 304 ft. Water 126ft from surface
Supply 400 gallons per hour. Good water

No 41 Bore. Depth 416ft. Water 128ft from surface
Supply 400 Gallons per hour. Water not so good as No 40, but drinkable.

No 42 Plant Commencing on this site