

PLAN OF SUBDIVISION OF THE LITTLE RIVER ESTATE,

The Property of the Estate of the late JOHN MOFFATT,

Situated close to LITTLE RIVER RAILWAY STATION,
NEAR GEELONG, VICTORIA.

To be offered in lots, as per Plan, at Public Auction, at

THE WOOL EXCHANGE, THE OLDERFLEET,

Collins Street, Melbourne, on

FRIDAY, 16TH OCTOBER, 1903, AT 3 P.M.,

By POWERS, RUTHERFORD & COY.
HOWE & CAMPBELL
FISKEN, READ & COY.
THORNTON, PALMER & COY.

Auctioneers
in
Conjunction.

TERMS:—10 per cent. on signing Contract. Balance, to make up one-third, on 22nd December next, when possession will be given.

Balance purchase-money to be payable on 22nd December, 1908, with interest calculated from 22nd December next, at $4\frac{1}{2}$ per cent., payable half-yearly.

Each purchaser to have the option of paying the whole of his purchase-money in cash on, or at any time prior to, 1st March, 1904.

SOLICITORS:

WHITING & AITKEN,

101 WILLIAM STREET,

MELBOURNE.

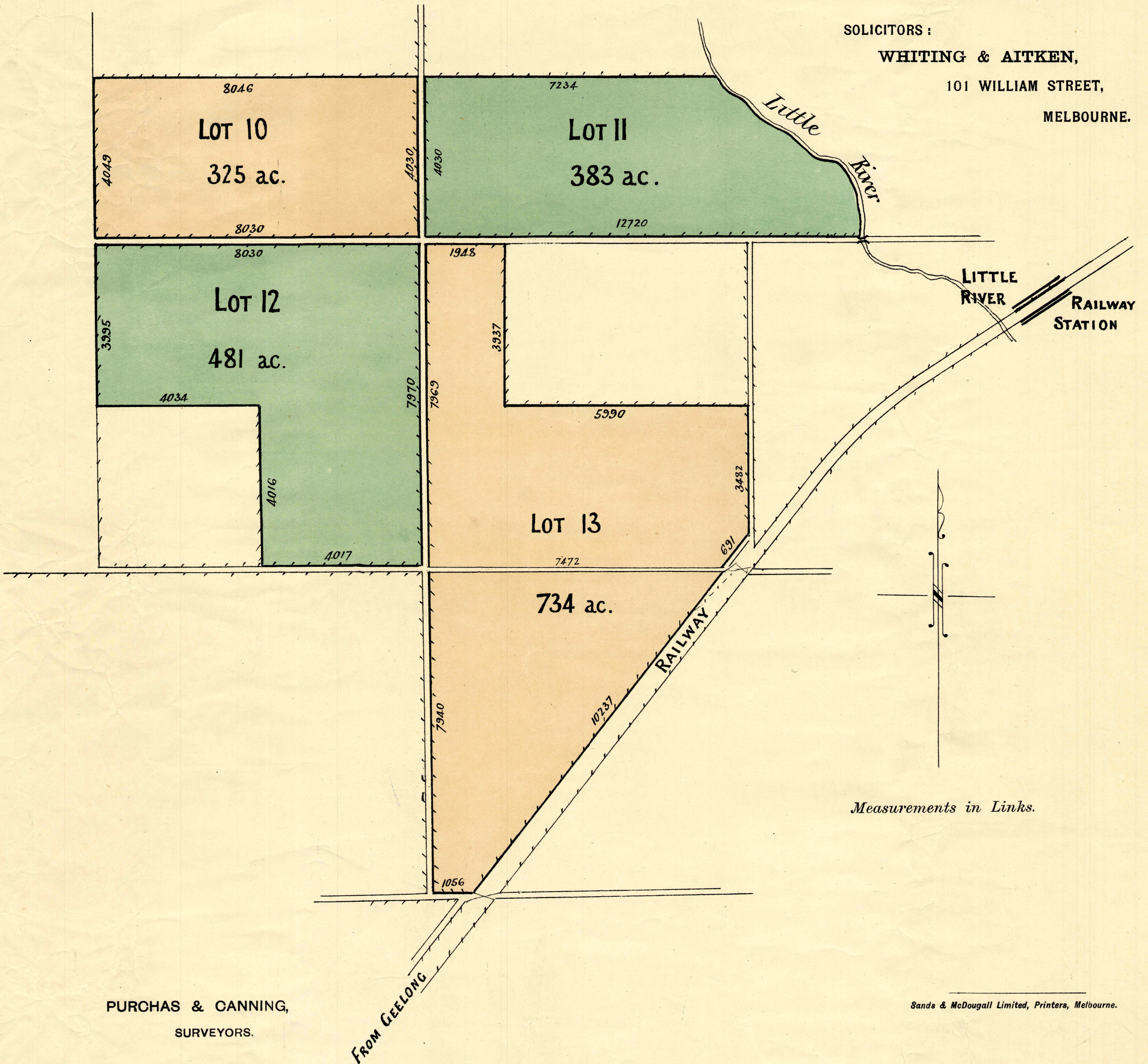

Measurements in Links.

PURCHAS & CANNING,
SURVEYORS.

Sands & McDougall Limited, Printers, Melbourne.