

PLAN
 OF SUBDIVISION OF
 PART OF PORTIONS 153 163 AND 164
 AT WICKHAM
PARISH OF NEWCASTLE COUNTY OF NORTHUMBERLAND
 SCALE 80 FEET TO AN INCH

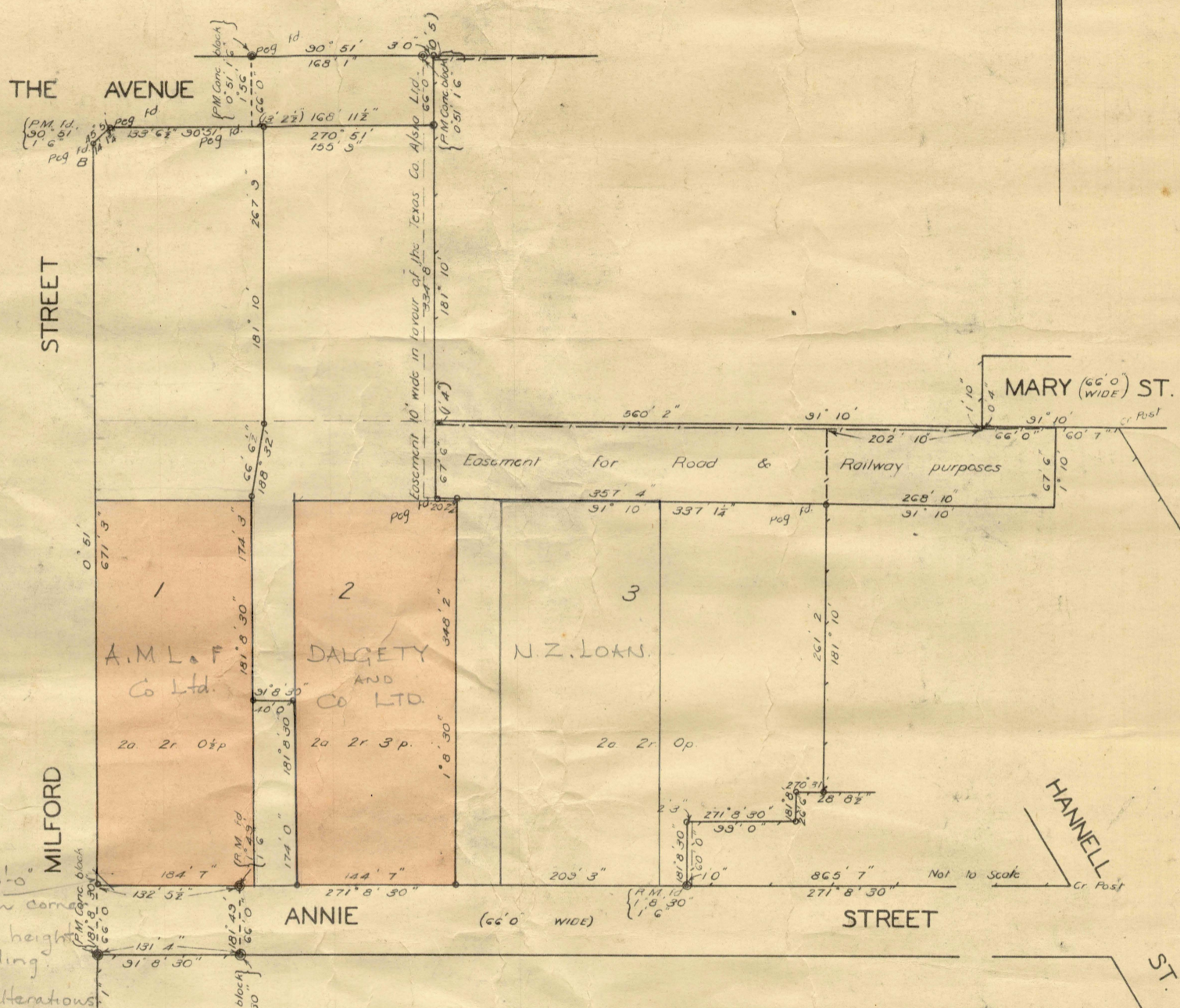

This entails alterations to roof to show floor and lavatories on ground 2nd floors and also to front Elevation.

It is intended to dedicate the extension of The Avenue and Annie Street to the public

Permanent marks are concrete blocks

The Common Seal of Grant Bros. Pty. Limited was hereunto duly affixed by the Chairman of the Board in the presence of two Directors whose signatures are set opposite hereunto

H. Vincent Trench
H. Vincent Trench

Approved by Council & Covered by Council Clerk's Certificate
 No. 780 of 11th Novem. 1941
H. Vincent Young
 (MAYOR) Council Clerk

Subscribed and declared before me at Newcastle this 31st day of October A.D. 1941.

John W. Allen

I HENRY VINCENT TRENCH of NEWCASTLE, N.S.W. a Surveyor registered under the Surveyors Act, 1929, do hereby solemnly and sincerely declare (a) that all boundaries and measurements shown on this plan are correct (b) that all survey marks found and relevant physical objects on or adjacent to the boundaries are correctly represented (c) that all physical objects indicated actually exist in the positions shown (d) that the whole of the material facts in relation to the land are correctly represented (e) that the survey represented in this plan has been made in accordance with the Survey Practice Regulations, 1933, (1) by me (2) under my supervision, the character and extent of which was as required by the Survey Practice Regulations, 1933, and was completed on 29th October, 1941, and the Permanent Marks have been placed as shown hereon.

And I make this solemn declaration conscientiously believing the same to be true and by virtue of the provision of the Oaths Act, 1900.

Signature *H. Vincent Trench*
 Surveyor registered under Surveyors Act, 1929.