

UARDRY HOLDING

CENTRAL DIVISION N^o 315

COUNTY OF STURT

Land District of Hay

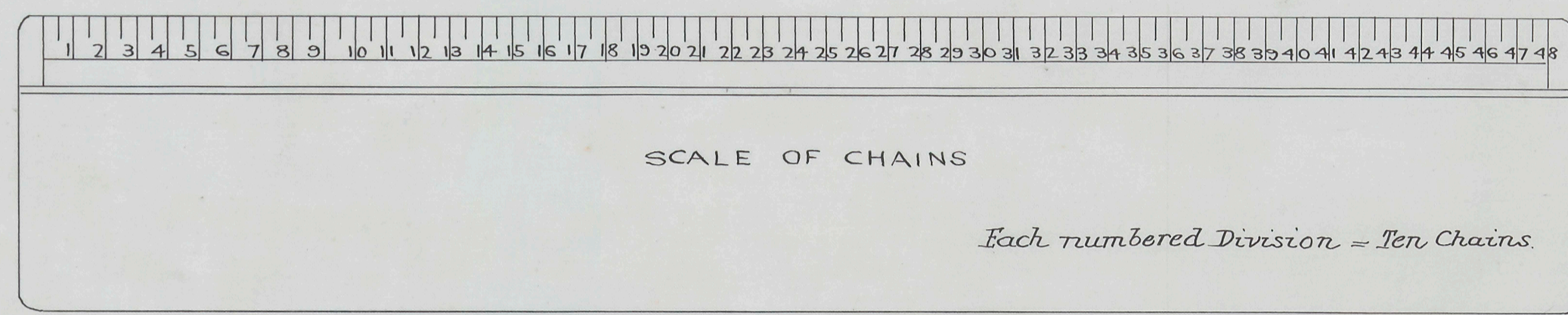

F.W. BIDEN DRAFTSMAN 2 Spring St Sydney 7th Nov 1935

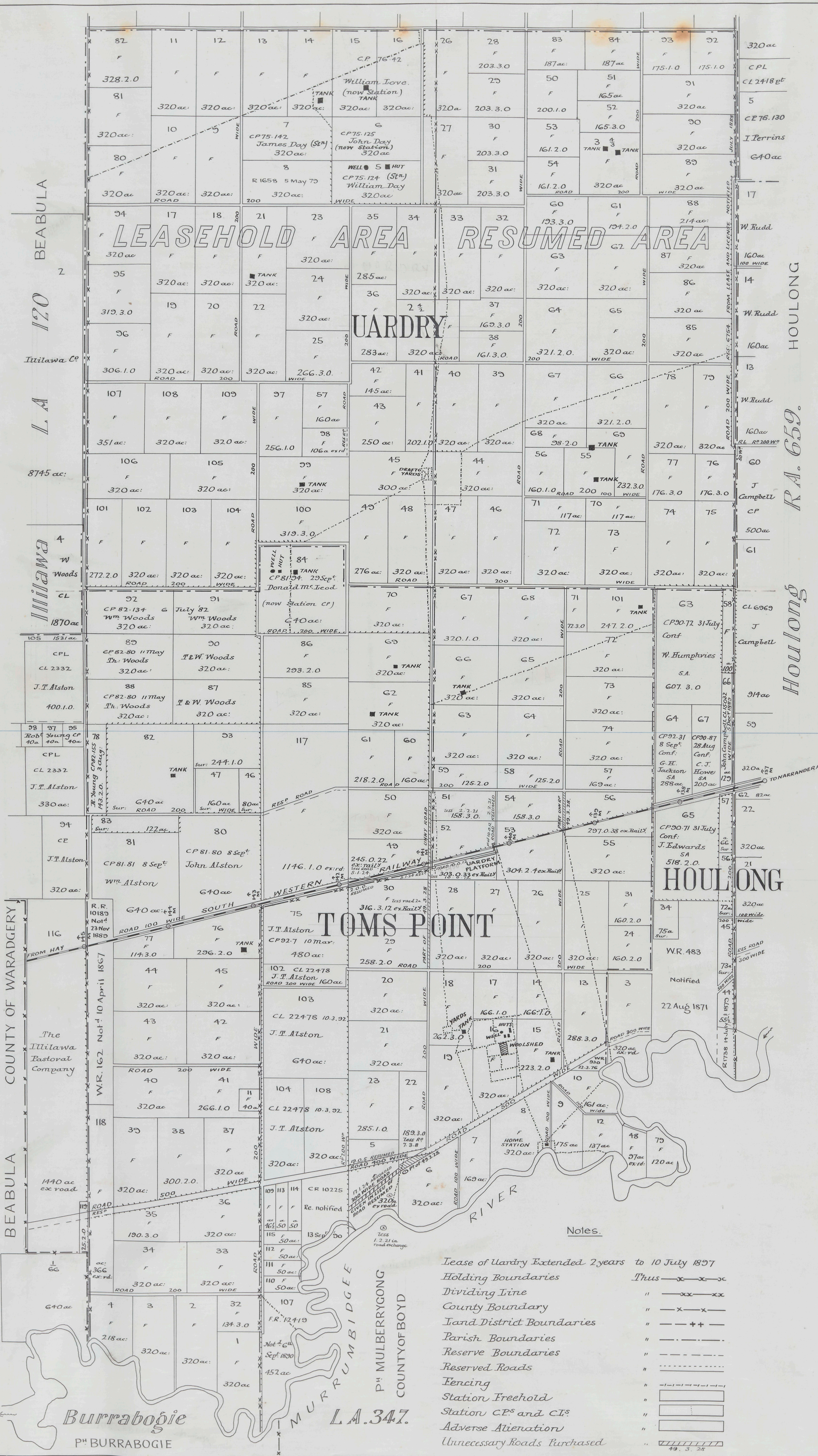
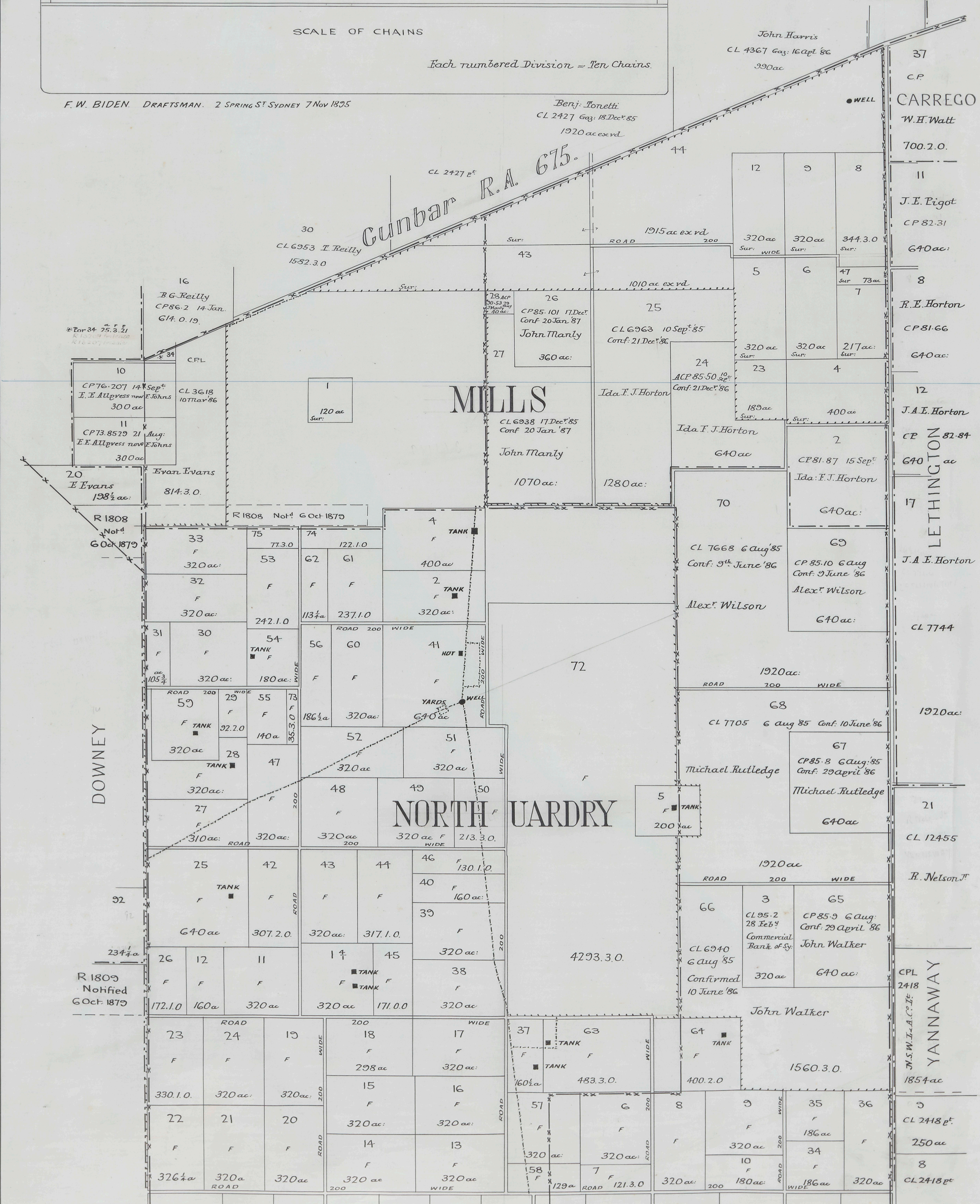

- Notes.
- Lease of Uardry Extended 2 years to 10 July 1937
 - Holding Boundaries Thus ————
 - Dividing Line " ————
 - County Boundary " ————
 - Land District Boundaries " ————
 - Parish Boundaries " ————
 - Reserve Boundaries " ————
 - Reserved Roads " ————
 - Fencing " ————
 - Station Freehold " ————
 - Station C^o and C^o " ————
 - Adverse Attention " ————
 - Unnecessary Roads Purchased " ————