

# MOUNT PLEASANT. (MULLINGAWARRINA).

## FOR ADDITIONAL HOLDINGS.

Lands available for application for  
Western Lands Lease.

### COUNTY OF COWPER.

ADMINISTRATIVE DISTRICT OF BOURKE.

SCALE: ONE MILE TO AN INCH.

NOTE: It is not intended to grant a lease to a person whose nearest parcel of land would be more than 25 miles by practicable road with a narrow margin beyond that distance in very special cases.

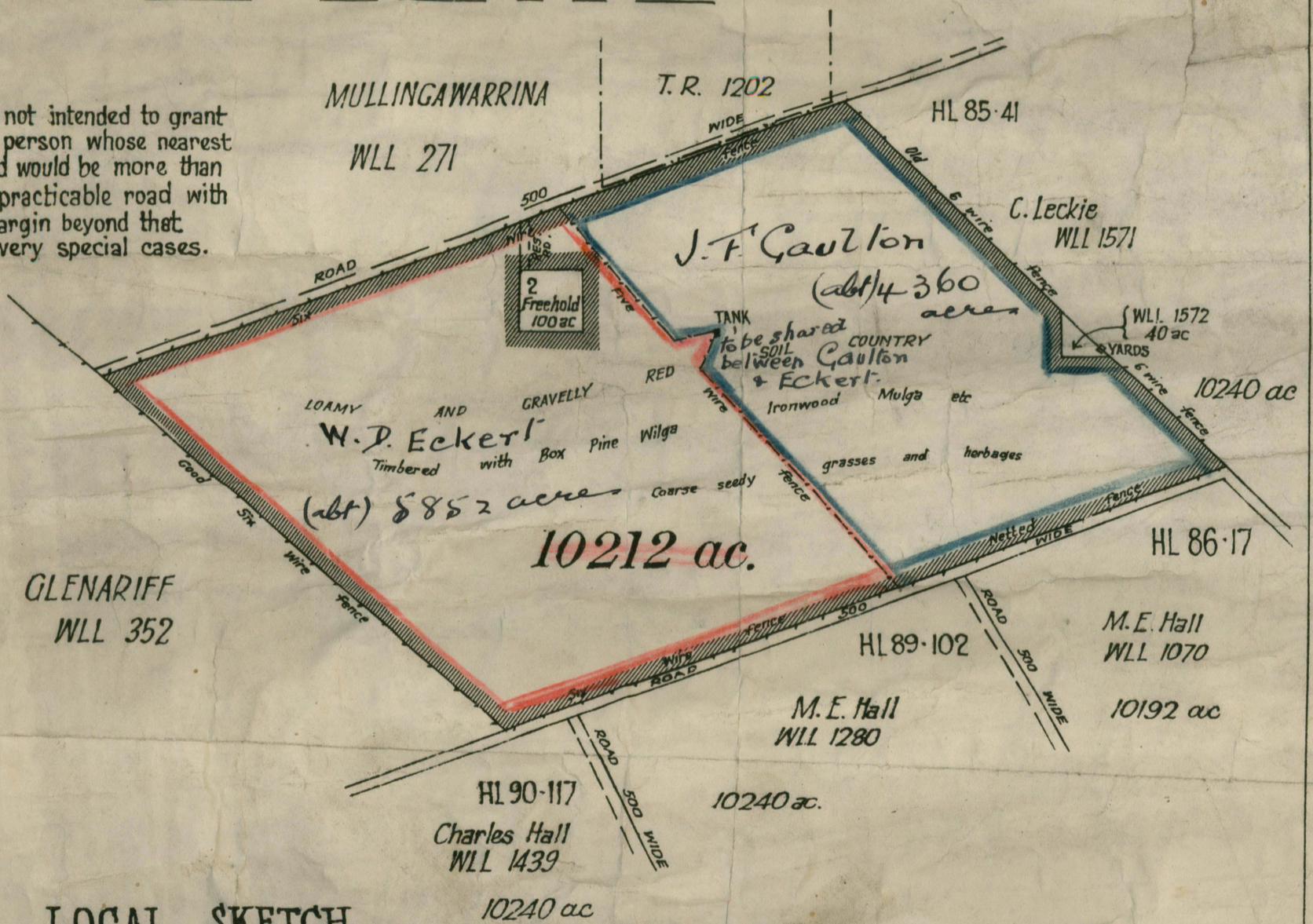

LOCAL SKETCH.

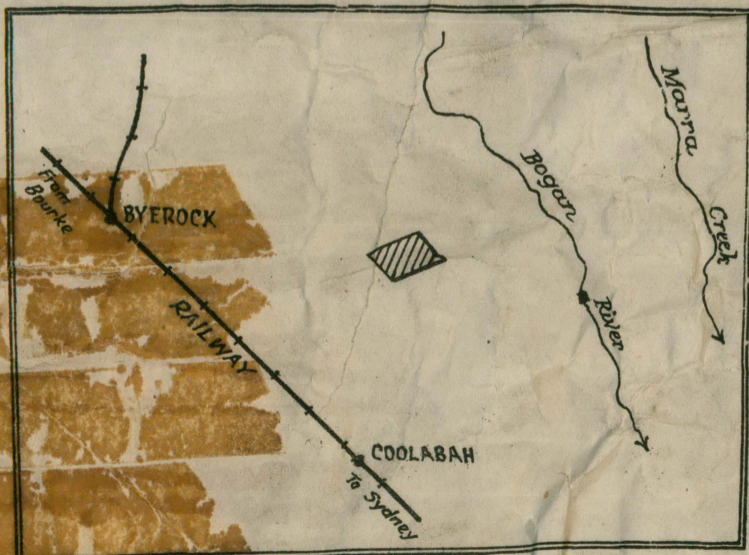

SCALE: 16 MILES TO AN INCH.

Lands available for Western  
Lands Lease shown thus :- 

Available exclusively to holders of land under any tenure in the Central or Western Divisions within reasonable working distance.

Available on and after 6th. Sept. 1943  
Applications received between that date and 19th. Nov. 1943 shall be deemed to be made simultaneously.

The Local Land Board will sit at Bourke to deal with applications on a date to be notified to applicants.