

2824  
 933  
 3757  
 3257

5994  
 1480  
 1905  
 1600  
 3000  
 13979

LYNGFORDS CAMP. 2480 ACRES

FOUR MILE. 1785 ACRES.

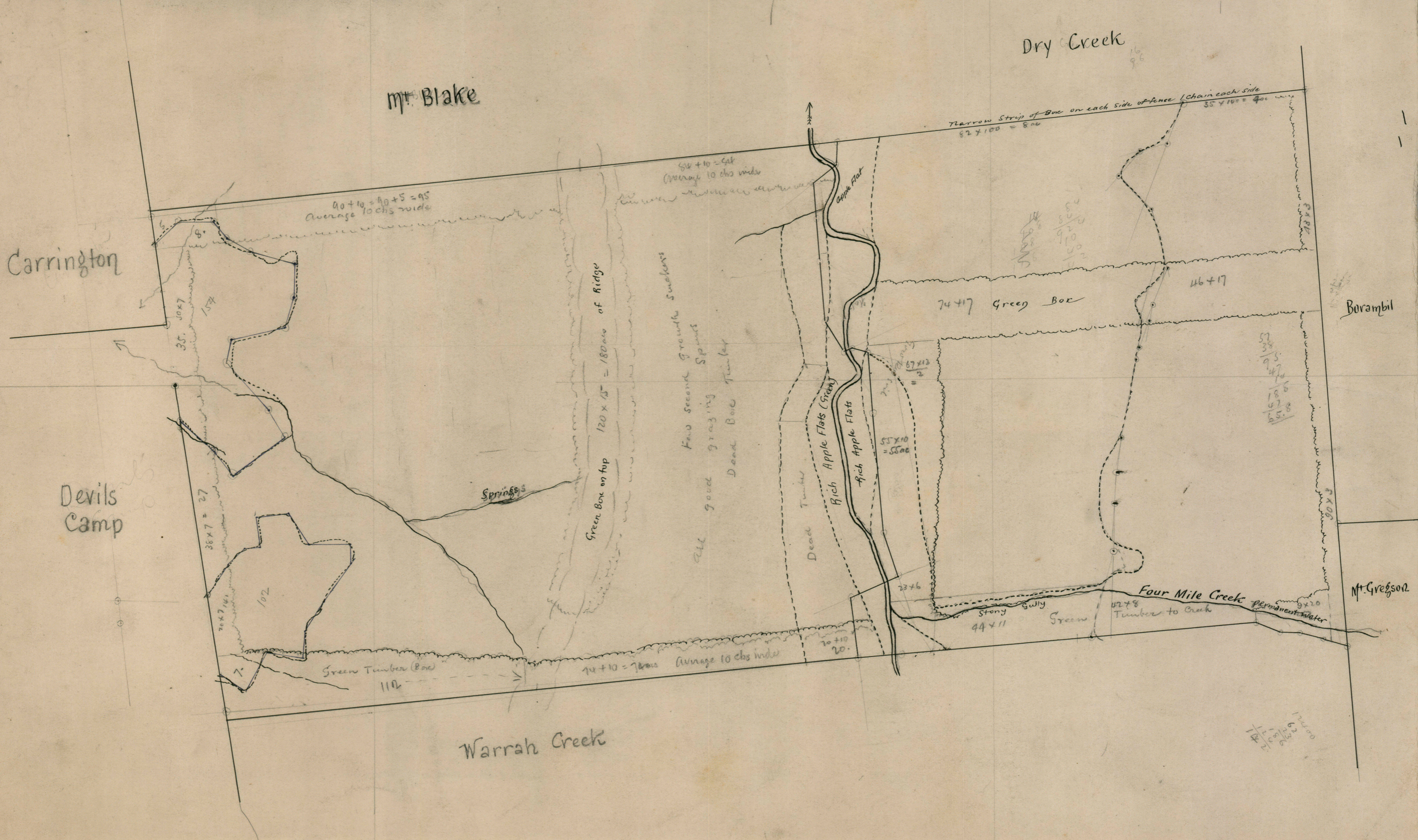

Carrington

Devils Camp

Mt. Blake

Dry Creek

Warrak Creek

Borambl

Mt. Gregson

$90+10+40+5=95$   
 Average 10 chs wide

$60+10=70$   
 Average 10 chs wide

Narrow Strip of Bone on each side of fence 1 chain each side  
 $55 \times 100 = 5500$   
 $52 \times 100 = 5200$

Green Box on top  $120 \times 15 = 1800$  ac of Ridge

Few second growth suckers  
 all good grazing  
 Dead Box Timber

74+17 Green Box

46+17

Rich Apple Flats (Green)  
 Rich Apple Flats

$55 \times 10 = 550$  ac

Green Timber Box  
 110

$70+10=80$  ac Average 10 chs wide

$70+10=80$

Stony Gully

Green

42+8  
 Timber to Creek

Four Mile Creek permanent water

$\frac{12000}{100} = 120$   
 $\frac{12000}{100} = 120$   
 $\frac{12000}{100} = 120$

$\frac{17}{17} = 1$   
 $\frac{20}{20} = 1$

$\frac{14}{14} = 1$   
 $\frac{50}{50} = 1$   
 $\frac{92}{92} = 1$   
 $\frac{10}{10} = 1$   
 $\frac{10}{10} = 1$

$\frac{57}{57} = 1$   
 $\frac{21}{21} = 1$   
 $\frac{44}{44} = 1$   
 $\frac{16}{16} = 1$   
 $\frac{18}{18} = 1$   
 $\frac{6}{6} = 1$   
 $\frac{5}{5} = 1$   
 $\frac{8}{8} = 1$