

• LOCAL SKETCH •

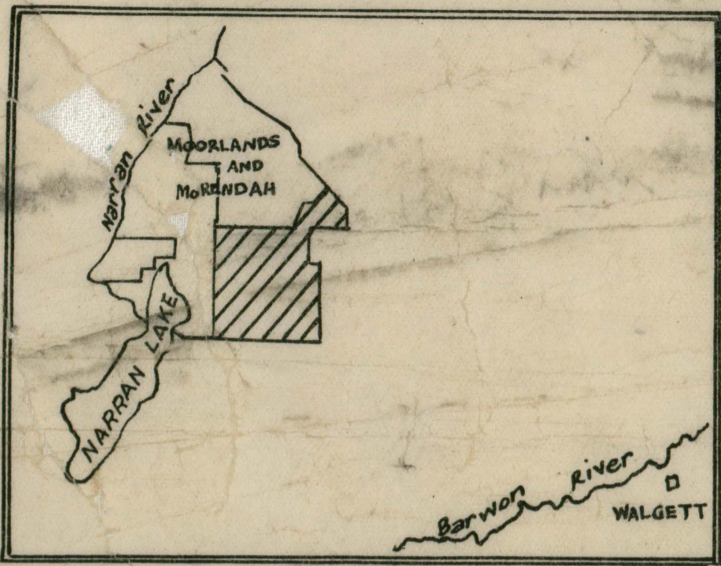

— SCALE 16 MILES TO AN INCH —

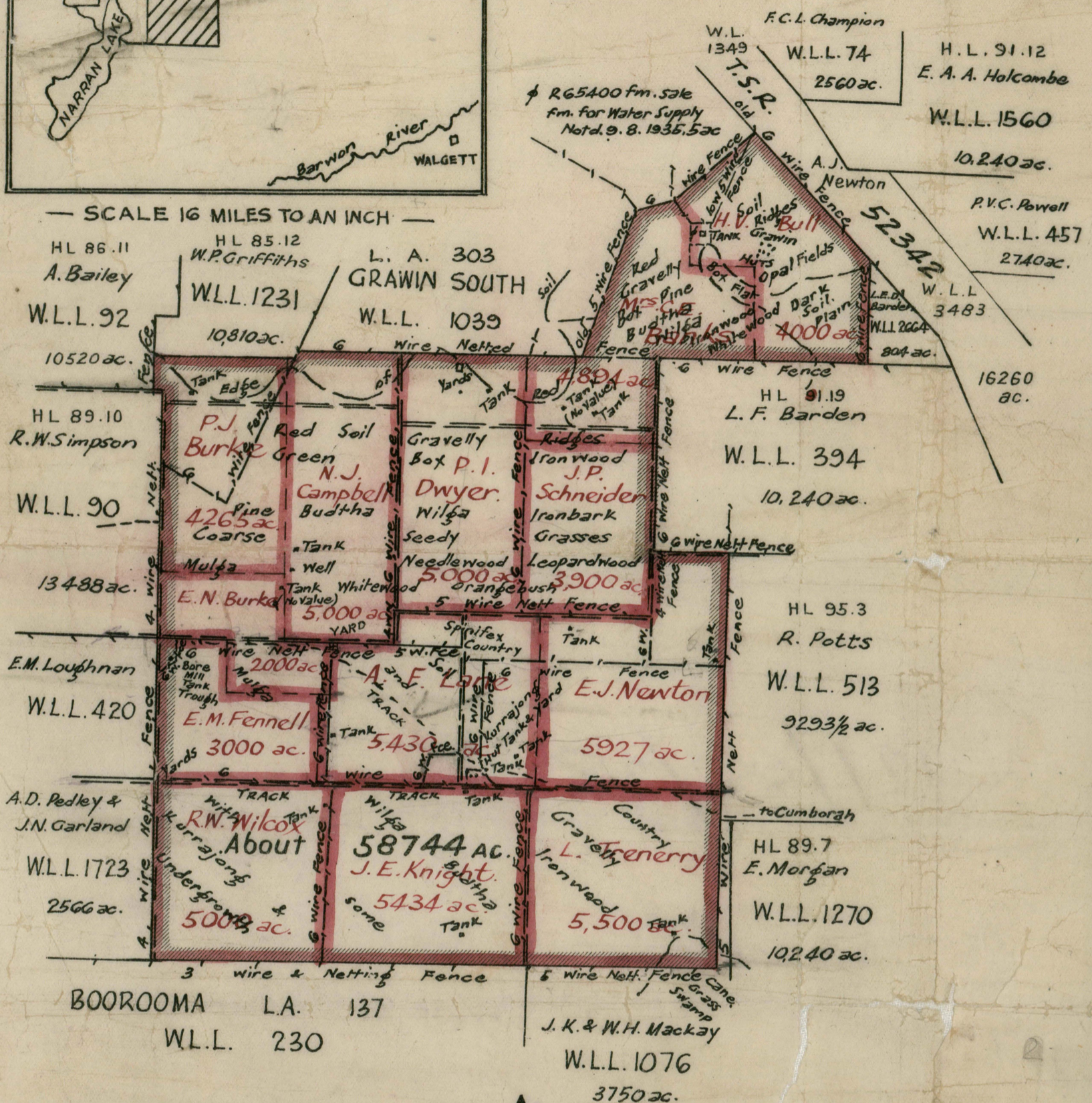

MOORLANDS AND MORENDAH •

Lands Available for application for Western Lands Lease

COUNTY OF FINCH

Scale 2 Miles to an Inch

Compiled, Drawn and printed at the Department of Lands, Sydney, N.S.W. 25-937

Available exclusively to holders of land under any tenure in the Central or Western Division within reasonable working distance.

Available on and after 26th August 1935. Applications received between that date and 18th October 1935, shall be deemed to be made simultaneously.

The Local Land Board will sit at Walgett on 9th December 1935 to deal with applications.

Note :- Lands available for Western Lands Lease shown th