

A.A. COY'S PORT STEPHENS ESTATE

3993 Acres.

Auction sale of land at Ennogera
Widgee

Lots 1 to 12 Parish of M^t George

To be offered for sale by PUBLIC AUCTION at **STROUD**

At their Rooms on the 11th May 1905. By

M^{rs} KENZIE & HOOKE AUCTIONEERS STROUD.

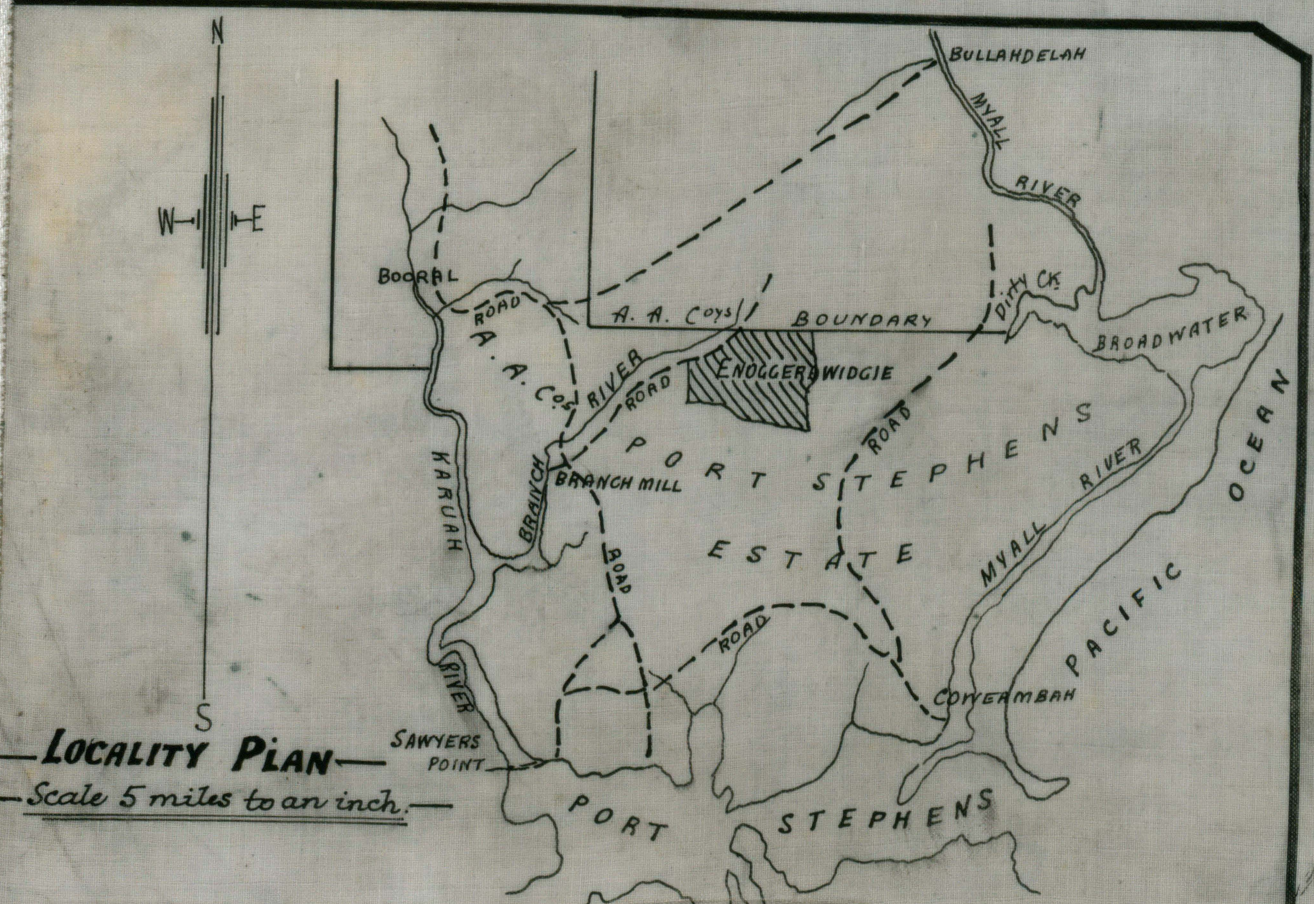
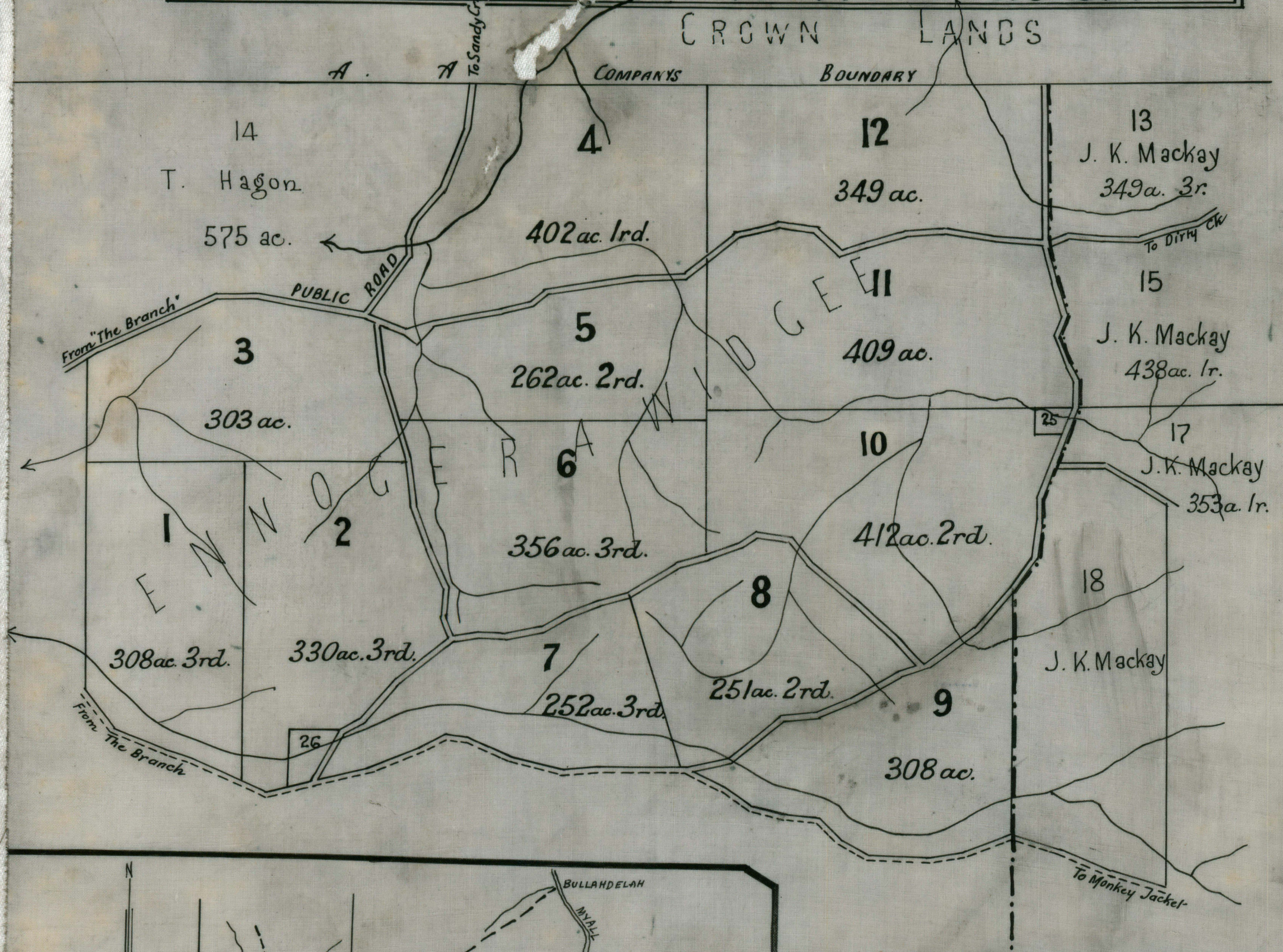

NOTE. All roads are 1 Chain wide.

TERMS.

$\frac{1}{5}$ Cash: Balance by equal annual instalments covered by P.N.s. with 3% per annum added. Purchasers of up to £100 value, are required to pay the balance in 2 years, and for each £50 above that amount, 1 year in addition will be allowed in which to complete the purchase.