

Plan of Lot 709

Johnson's Creek

Sebastian Weismantel

Date of Survey 2/10/91  
Azimuth a/b

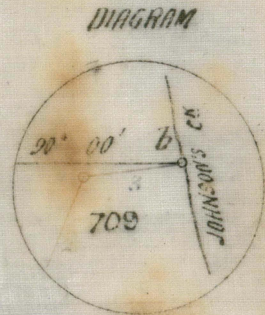
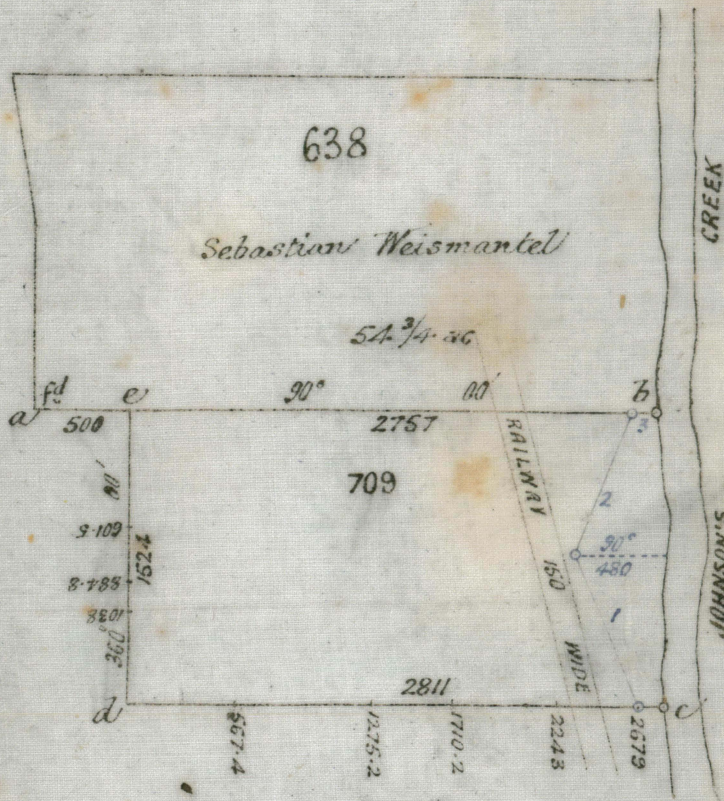

CORNERS

Cor	Bearing	From	Links
b	130° 34'	Ti Tree	33 3/4
c	246° 00'	Gum	4
d	75° 50'	Stringybark	10 1/2
e	38° 00'	Gum	46 1/2

TRAVERSE

Line	Bearing	Distance
1	337° 04'	852
2	21° 23'	787.6
3	87° 10'	125

A. F. Hall

L.S.