

COUNTY OF TOWNSEND

B

4313

PARISH OF YALOKE

PH OF GOHA

PARISH OF YALAMA

PARISH OF GUDOCK

PARISH OF COTHOG

COUNTY BOUNDARY

PARISH OF BOYD

PARISH OF NALLAM

PARISH OF MATHOURA

PARISH OF BUNNALDO

COUNTY OF CADELL

This plan is correct to date
15/9/58
M.R.P.

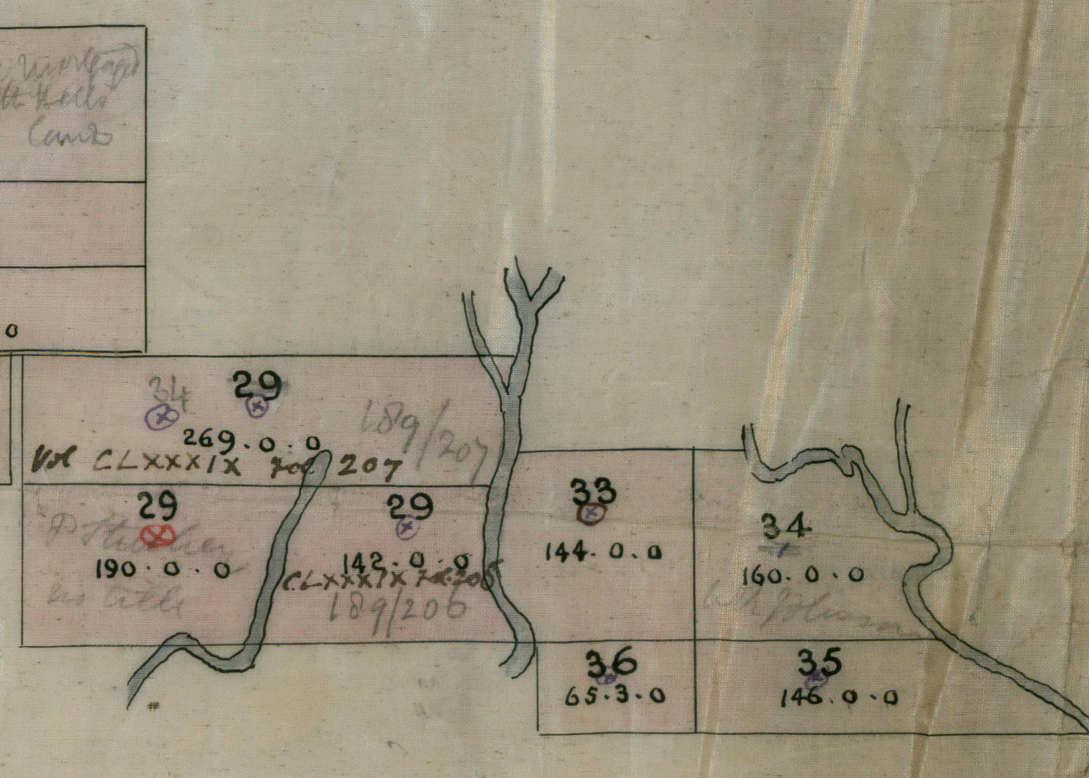
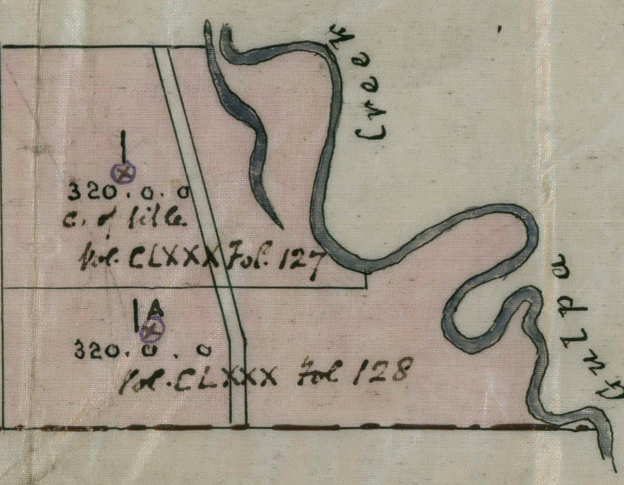
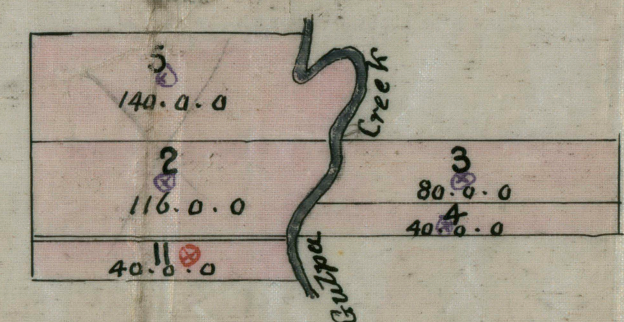

640
J. Powell
C.P.

Freehold
C.P.s. paying interest
I.P.s. appraised but not gazetted
I.P. (on Reserve) not yet appraised
Land to be sold at Auction
I.P. gazetted but not appraised
Adverse C.P.s. - orange spot.

Suburban Blocks and
Mathoura Town Common
Edged Blue

