

THIRD EDITION
PARISH OF ELI ELWAH
COUNTY OF WARADGERY
 LAND DISTRICT OF HAY
 WARADGERY SHIRE
 CENTRAL DIVISION N.S.W.

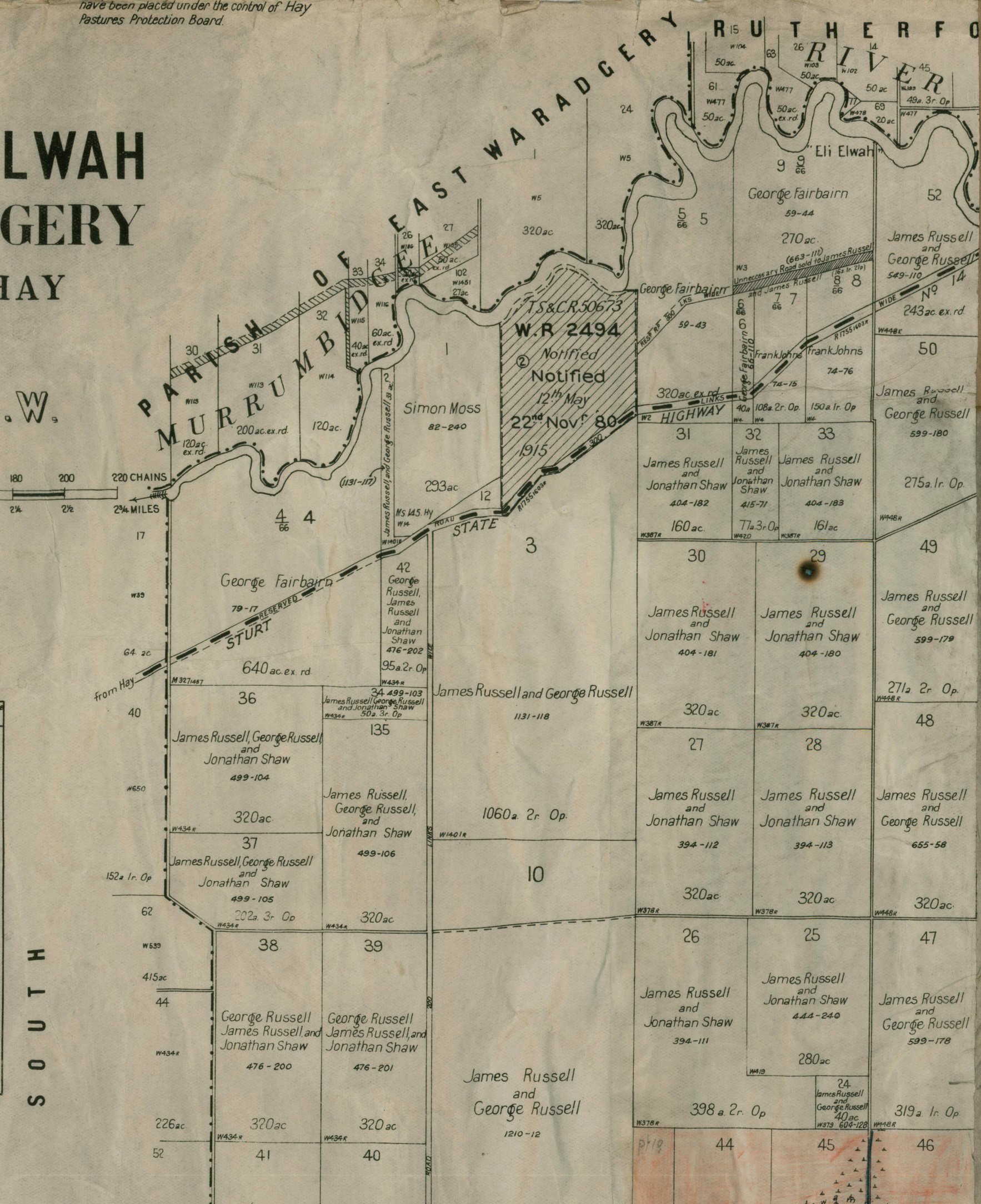
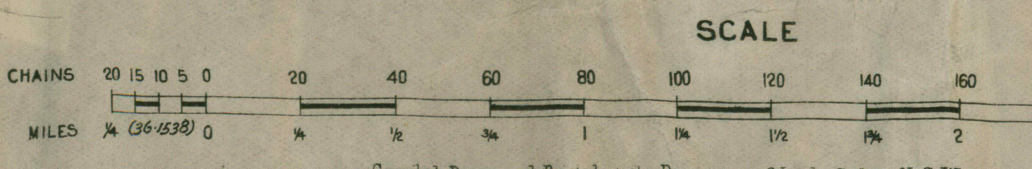

Permission to Enclose Roads or Watercourses

Papers	Applicant	Granted	Description
153 Schomburgk	W.L. Schomburgk	1878	Land for enclosure of the 153 Schomburgk
153 Schomburgk	W.L. Schomburgk	1878	Land for enclosure of the 153 Schomburgk
153 Schomburgk	W.L. Schomburgk	1878	Land for enclosure of the 153 Schomburgk

2nd EDITION
PARISH OF BRUSH
COUNTY OF WARADGERY
 LAND DISTRICT OF HAY
 WARADGERY SHIRE
 CENTRAL DIVISION N.S.W.

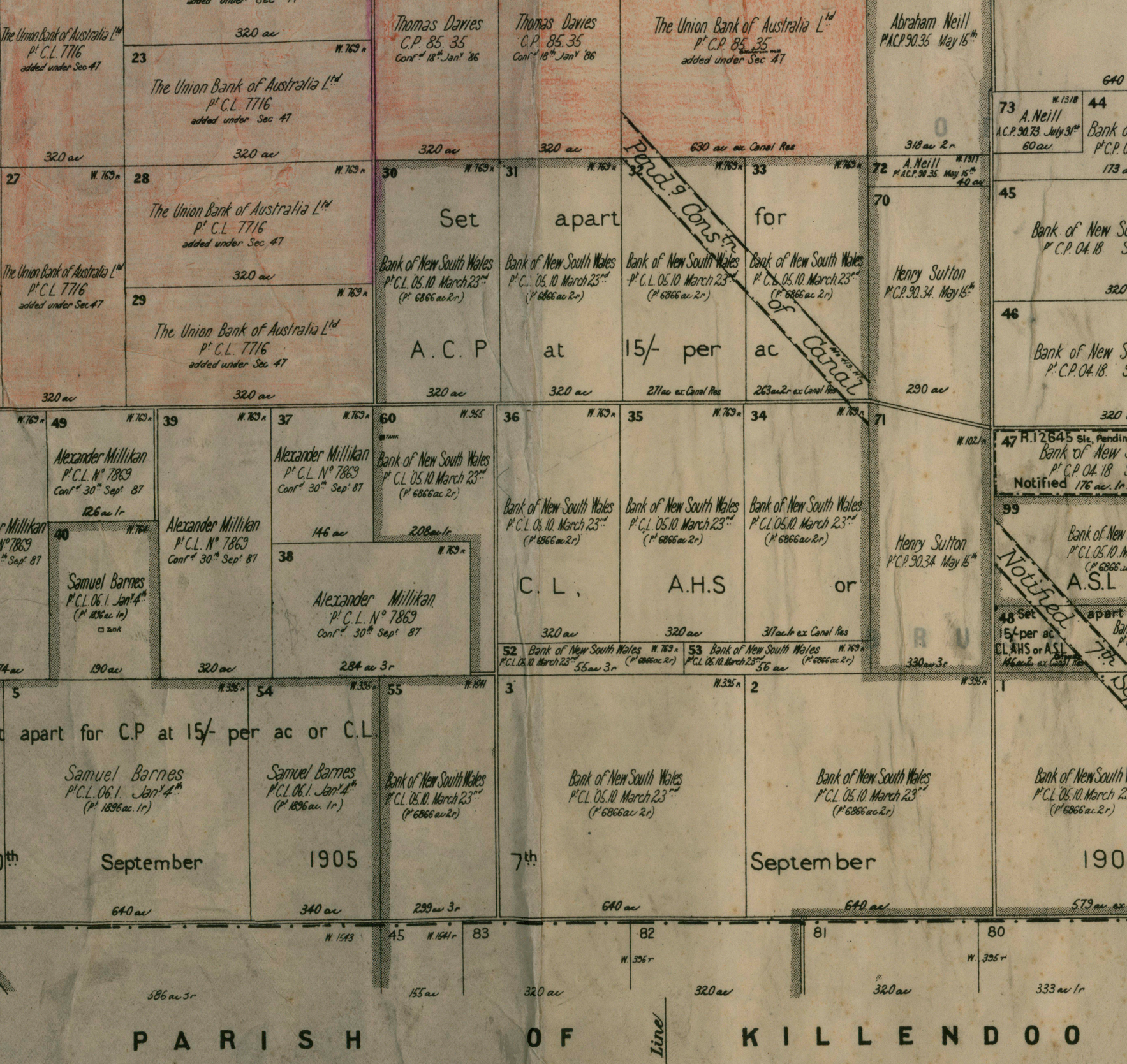
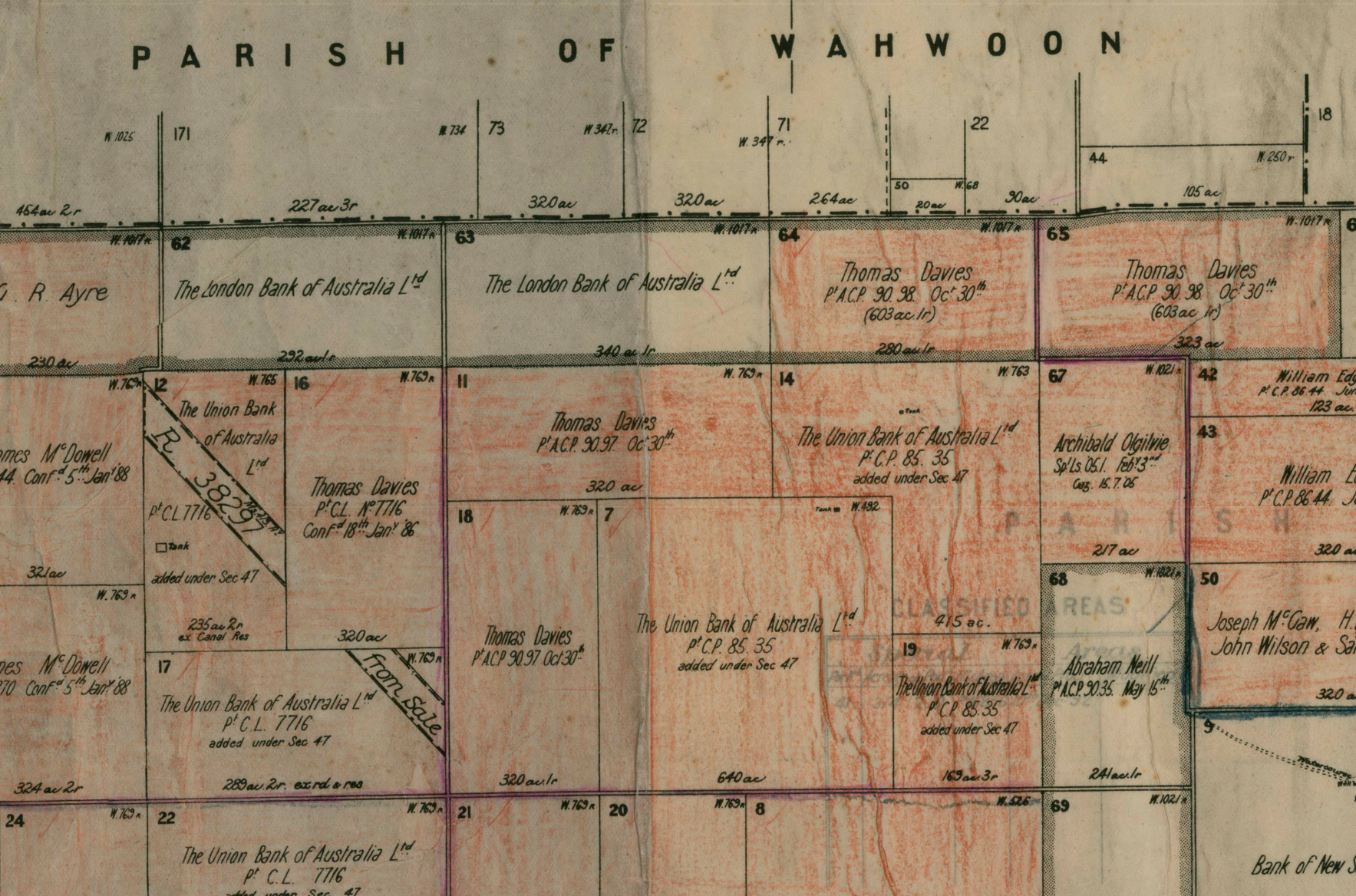
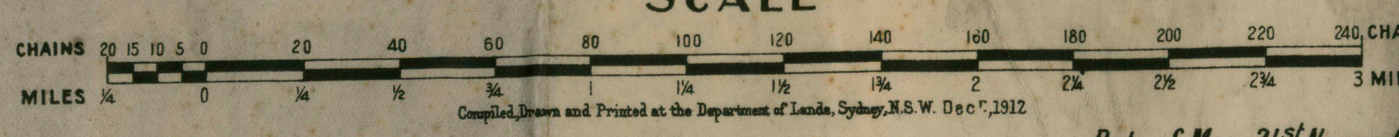

Permission to Enclose Roads or Watercourses

Papers	Applicant	Granted	Description
153 Schomburgk	W.L. Schomburgk	1878	Land for enclosure of the 153 Schomburgk
153 Schomburgk	W.L. Schomburgk	1878	Land for enclosure of the 153 Schomburgk
153 Schomburgk	W.L. Schomburgk	1878	Land for enclosure of the 153 Schomburgk

SECOND EDITION
PARISH OF WILGAH
COUNTY OF WARADGERY
 LAND DISTRICT OF HAY
 CENTRAL DIVISION N.S.W.

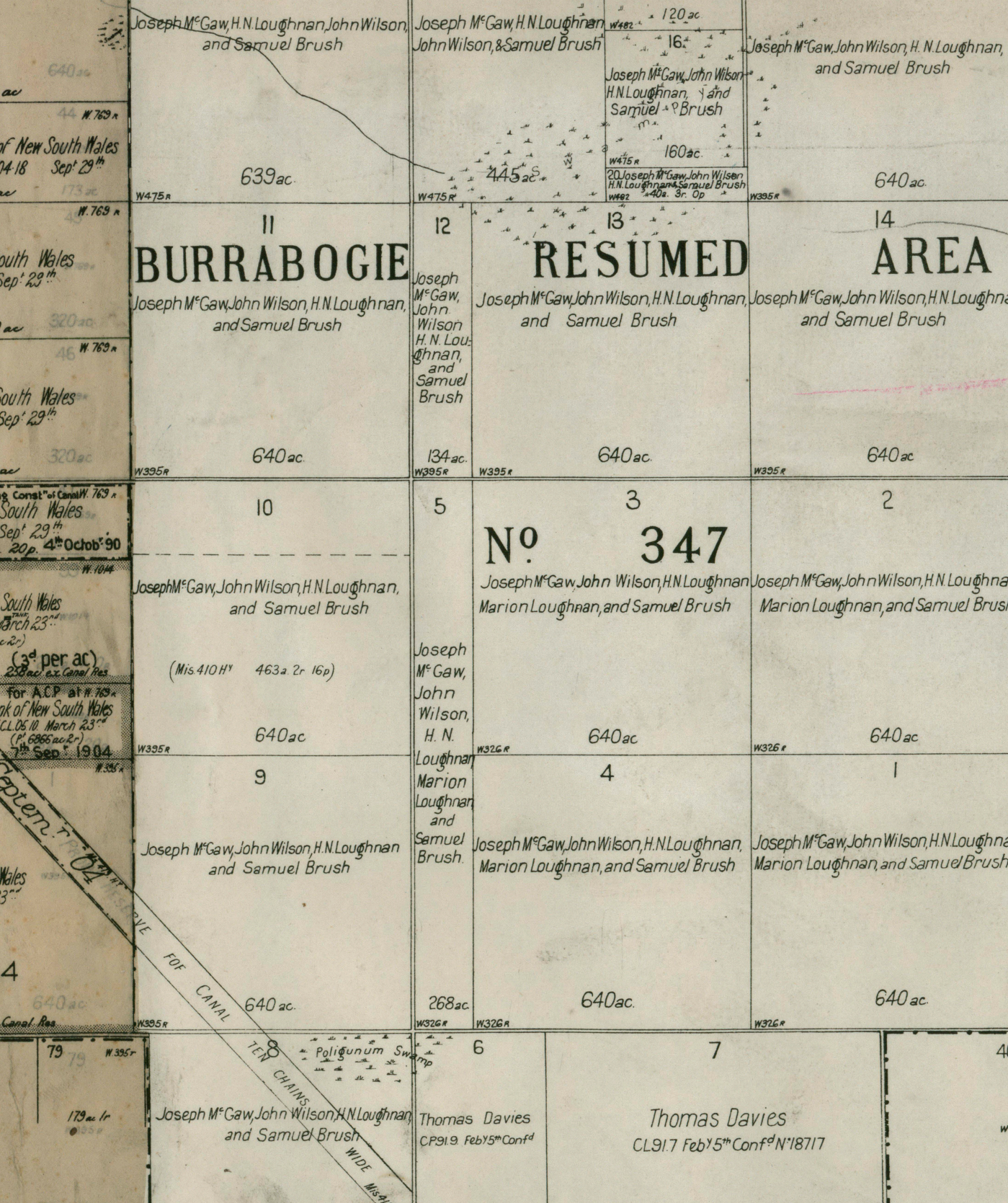
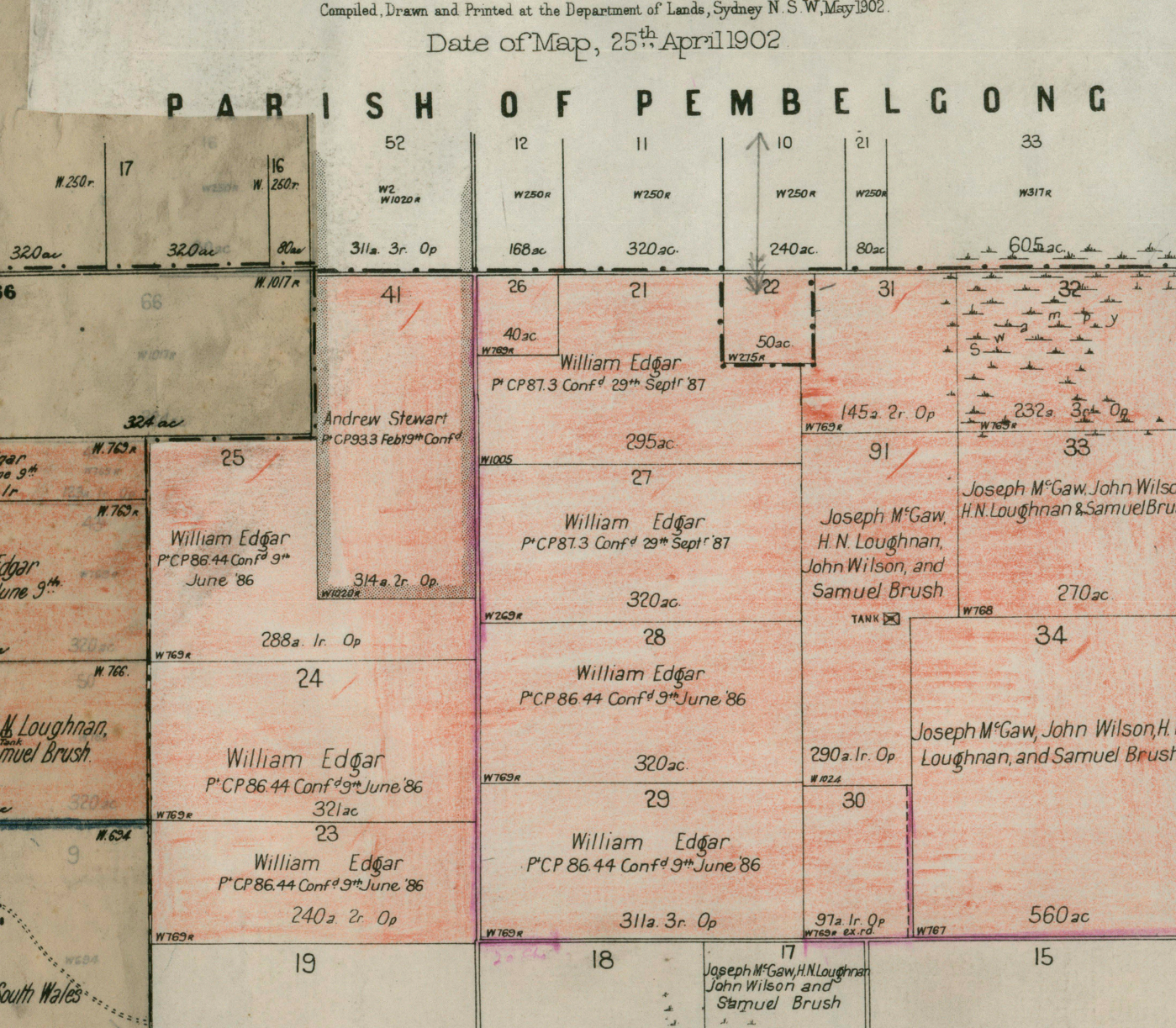
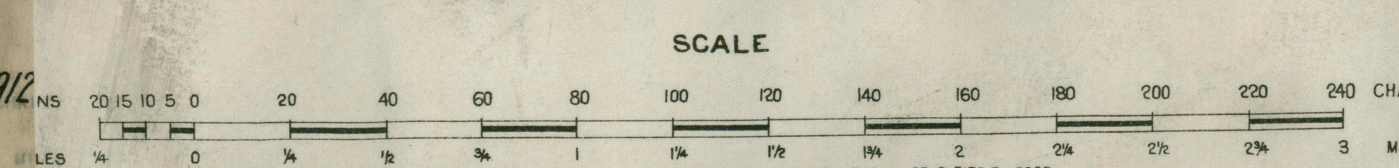

Permission to Enclose Roads or Watercourses

Papers	Applicant	Granted	Description
153 Schomburgk	W.L. Schomburgk	1878	Land for enclosure of the 153 Schomburgk
153 Schomburgk	W.L. Schomburgk	1878	Land for enclosure of the 153 Schomburgk
153 Schomburgk	W.L. Schomburgk	1878	Land for enclosure of the 153 Schomburgk

PARISH NUMBERS USED

Parish	Number	Area	Notes
1	1	1000	
2	2	1000	
3	3	1000	
4	4	1000	
5	5	1000	
6	6	1000	
7	7	1000	
8	8	1000	
9	9	1000	
10	10	1000	
11	11	1000	
12	12	1000	
13	13	1000	
14	14	1000	
15	15	1000	
16	16	1000	
17	17	1000	
18	18	1000	
19	19	1000	
20	20	1000	
21	21	1000	
22	22	1000	
23	23	1000	
24	24	1000	
25	25	1000	
26	26	1000	
27	27	1000	
28	28	1000	
29	29	1000	
30	30	1000	
31	31	1000	
32	32	1000	
33	33	1000	
34	34	1000	
35	35	1000	
36	36	1000	
37	37	1000	
38	38	1000	
39	39	1000	
40	40	1000	
41	41	1000	
42	42	1000	
43	43	1000	
44	44	1000	
45	45	1000	
46	46	1000	
47	47	1000	
48	48	1000	
49	49	1000	
50	50	1000	
51	51	1000	
52	52	1000	
53	53	1000	
54	54	1000	
55	55	1000	
56	56	1000	
57	57	1000	
58	58	1000	
59	59	1000	
60	60	1000	
61	61	1000	
62	62	1000	
63	63	1000	
64	64	1000	
65	65	1000	
66	66	1000	
67	67	1000	
68	68	1000	
69	69	1000	
70	70	1000	
71	71	1000	
72	72	1000	
73	73	1000	
74	74	1000	
75	75	1000	
76	76	1000	
77	77	1000	
78	78	1000	
79	79	1000	
80	80	1000	
81	81	1000	
82	82	1000	
83	83	1000	
84	84	1000	
85	85	1000	
86	86	1000	
87	87	1000	
88	88	1000	
89	89	1000	
90	90	1000	
91	91	1000	
92	92	1000	
93	93	1000	
94	94	1000	
95	95	1000	
96	96	1000	
97	97	1000	
98	98	1000	
99	99	1000	
100	100	1000	

NOTES
 R.56.46 Sale or Lease generally, 1st May, 1923. All beds of rivers, creeks and swamps in the Land of the District, and all rights, easements and other interests in or adjacent thereto, of Crown Lands between the banks of such rivers etc. and between such banks and adjacent land bordering the banks of such rivers, creeks and swamps. All such reservations not already reserved from sale for a public purpose or held under special lease, and all islands or parts of islands in the rivers, creeks and swamps, and all islands or parts of islands reserved from sale for a public purpose, shall under the reservation from sale under general order of 17th April, 1922, remain the property of the Crown as at 1st May, 1923.

All lands within a radius of one mile of all Public Schools declared Herd and Animal Sanctuaries, Sec. 3, Act No. 1918.

The following lands are exempted from Occupation under Moore's Right or Business License:
 All Crown Lands reserved or left as a road, street or lane and all Crown Lands shown on Official Maps as reserved for drainage and not reserved for sale for a public purpose.
 Crown Lands within any City, Town or Village, or site for same, reserved, reserved or set apart, present or future, and being within a gold or mineral field, Gazette 25th January, 1918.

State forests and Timber Reserves, present and future, Sec. 3, 1918.
 Lands which have been, or may be acquired for Settlement or Village purposes, R.102, Part III, 1918.

Areas of alienated Portions quoted on this Map are those at the date of issue of Crown Grant and have not been altered by reason of any reservation, etc. which may have occurred since that date.

Volume and Folio or date of Crown Grant shown after Grants name.

SMALL PORTION

PLAN	PURCHASER	AC	AREA
12	James Russell	1000	15 1/2

ROAD PERMITS

NO	DESCRIPTION
1	1/4 Sec 37 (P) 52, 50, 49, 48, 47, 46, 45, 44, 43, 42, 41, 40, 39, 38, 37, 36, 35, 34, 33, 32, 31, 30, 29, 28, 27, 26, 25, 24, 23, 22, 21, 20, 19, 18, 17, 16, 15, 14, 13, 12, 11, 10, 9, 8, 7, 6, 5, 4, 3, 2, 1

ROAD PERMITS

NO	DESCRIPTION
2	1/4 Sec 37 (P) 52, 50, 49, 48, 47, 46, 45, 44, 43, 42, 41, 40, 39, 38, 37, 36, 35, 34, 33, 32, 31, 30, 29, 28, 27, 26, 25, 24, 23, 22, 21, 20, 19, 18, 17, 16, 15, 14, 13, 12, 11, 10, 9, 8, 7, 6, 5, 4, 3, 2, 1

ROAD PERMITS

NO	DESCRIPTION
3	1/4 Sec 37 (P) 52, 50, 49, 48, 47, 46, 45, 44, 43, 42, 41, 40, 39, 38, 37, 36, 35, 34, 33, 32, 31, 30, 29, 28, 27, 26, 25, 24, 23, 22, 21, 20, 19, 18, 17, 16, 15, 14, 13, 12, 11, 10, 9, 8, 7, 6, 5, 4, 3, 2, 1

ROAD PERMITS

NO	DESCRIPTION
4	1/4 Sec 37 (P) 52, 50, 49, 48, 47, 46, 45, 44, 43, 42, 41, 40, 39, 38, 37, 36, 35, 34, 33, 32, 31, 30, 29, 28, 27, 26, 25, 24, 23, 22, 21, 20, 19, 18, 17, 16, 15, 14, 13, 12, 11, 10, 9, 8, 7, 6, 5, 4, 3, 2, 1

ROAD PERMITS

NO	DESCRIPTION
5	1/4 Sec 37 (P) 52, 50, 49, 48, 47, 46, 45, 44, 43, 42, 41, 40, 39, 38, 37, 36, 35, 34, 33, 32, 31, 30, 29, 28, 27, 26, 25, 24, 23, 22, 21, 20, 19, 18, 17, 16, 15, 14, 13, 12, 11, 10, 9, 8, 7, 6, 5, 4, 3, 2, 1

ROAD PERMITS

NO	DESCRIPTION
6	1/4 Sec 37 (P) 52, 50, 49, 48, 47, 46, 45, 44, 43, 42, 41, 40, 39, 38, 37, 36, 35, 34, 33, 32, 31, 30, 29, 28, 27, 26, 25, 24, 23, 22, 21, 20, 19, 18, 17, 16, 15, 14, 13, 12, 11, 10, 9, 8, 7, 6, 5, 4, 3, 2, 1

ROAD PERMITS

NO	DESCRIPTION
7	1/4 Sec 37 (P) 52, 50, 49, 48, 47, 46, 45, 44, 43, 42, 41, 40, 39, 38, 37, 36, 35, 34, 33, 32, 31, 30, 29, 28, 27, 26, 25, 24, 23, 22, 21, 20, 19, 18, 17, 16, 15, 14, 13, 12, 11, 10, 9, 8, 7, 6, 5, 4, 3, 2, 1