

PLAN

SHEWING THE ESTATE

OF THE

PEEL RIVER LAND & MINERAL CO. LTD.

COUNTY OF PARRY

N. S. W.

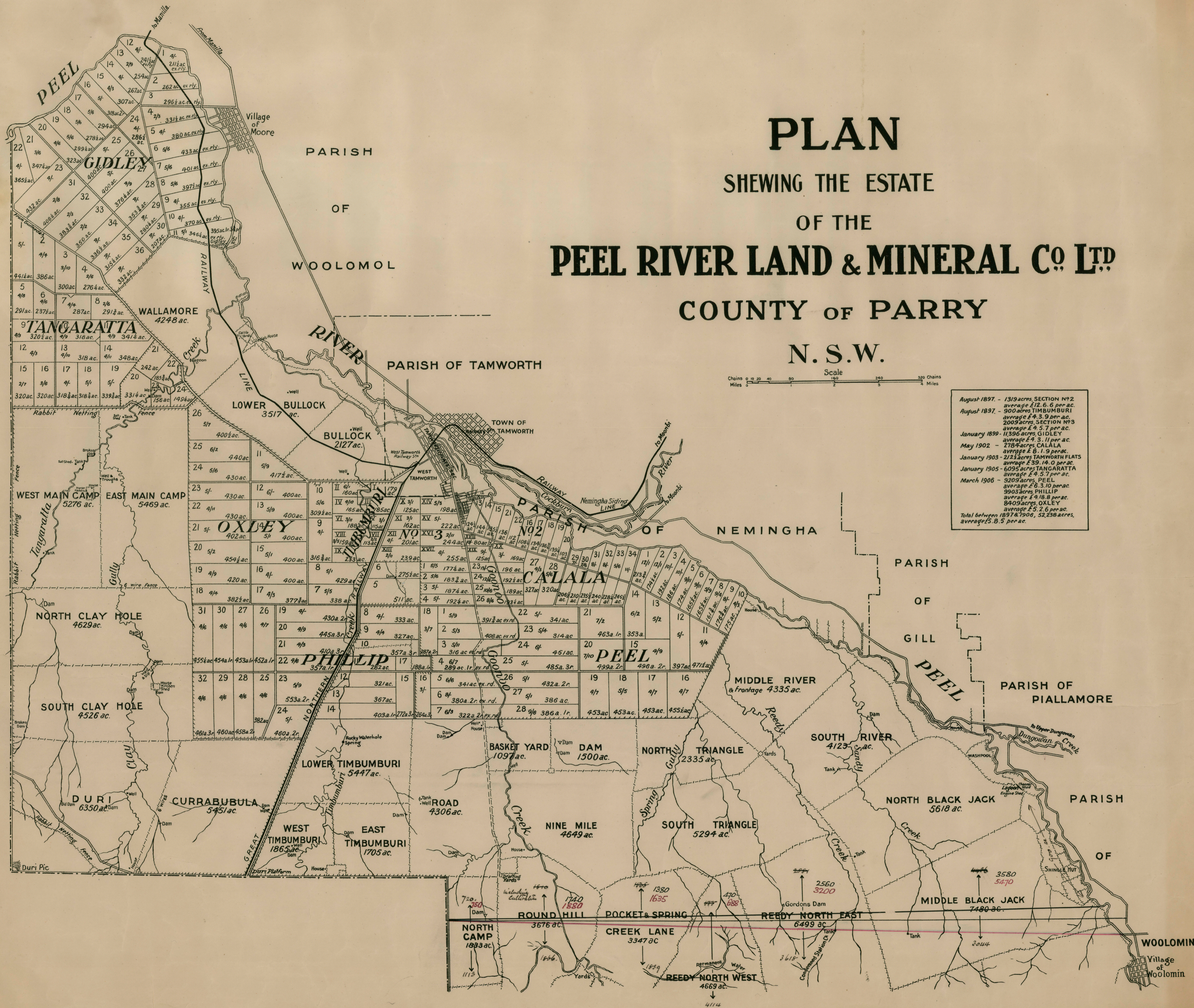

Scale
 Chains 0 10 20 40 80 160 240 320
 Miles 0 1 2 3 4

August 1897 - 1319 acres, SECTION No 2
 average £12.6.6 per ac.
 August 1897 - 900 acres, TIMBUMBURI
 average £4.3.9 per ac.
 2005 acres, SECTION No 3
 average £4.5.7 per ac.
 January 1899 - 11,306 acres, GIDLEY
 average £4.3.11 per ac.
 May 1902 - 2784 acres, CALALA
 average £8.1.9 per ac.
 January 1903 - 2123 acres, TAMWORTH FLATS
 average £39.14.0 per ac.
 January 1905 - 6095 acres, TANGARATTA
 average £4.5.7 per ac.
 March 1906 - 3205 acres, PEEL
 average £6.3.10 per ac.
 3903 acres, PHILLIP
 average £4.18.8 per ac.
 8405 acres, OXLEY
 average £5.2.6 per ac.
 Total between 1897 & 1906, 52,258 acres,
 average £5.8.5 per ac.