

CHAMFER 0.5 ON  
TOP EDGES TO  
ENSURE 4307-14A/B  
AND 6012 SEAT  
PROPERLY

12 LUGS  $14^{\circ}45' \pm 06'$   
EQUISPACED  $\pm 03'$

$\text{C} \begin{array}{|c|} \hline 0.020 \\ \hline \end{array} \begin{array}{|c|} \hline A \\ \hline \end{array}$

MATE WITH 4402,  
ENSURING THAT  
LUGS SEAT PROPERLY  
IN GROOVES IN 4402  
(ADJUST CHAMFERS  
IF NECESSARY)

CHAMFER 0.5 ON  
BOTTOM EDGES

$\phi 53.600 / 53.500$

$\phi 19.5 \pm 01$

2 HOLES  $\phi 9.7 / 9.8$   
EQUISPACED ON PCD 38

6 SPLINE GROOVES  $30^{\circ}00' \pm 06'$   
EQUISPACED  $\pm 03'$

$\text{C} \begin{array}{|c|} \hline 0.020 \\ \hline \end{array} \begin{array}{|c|} \hline A \\ \hline \end{array}$

$\phi 47.900$   
 $47.700$

M28 x 2 H7

$\phi 26.000 / 26.030$   
OVER THREADS  
FOR LOCATION

A

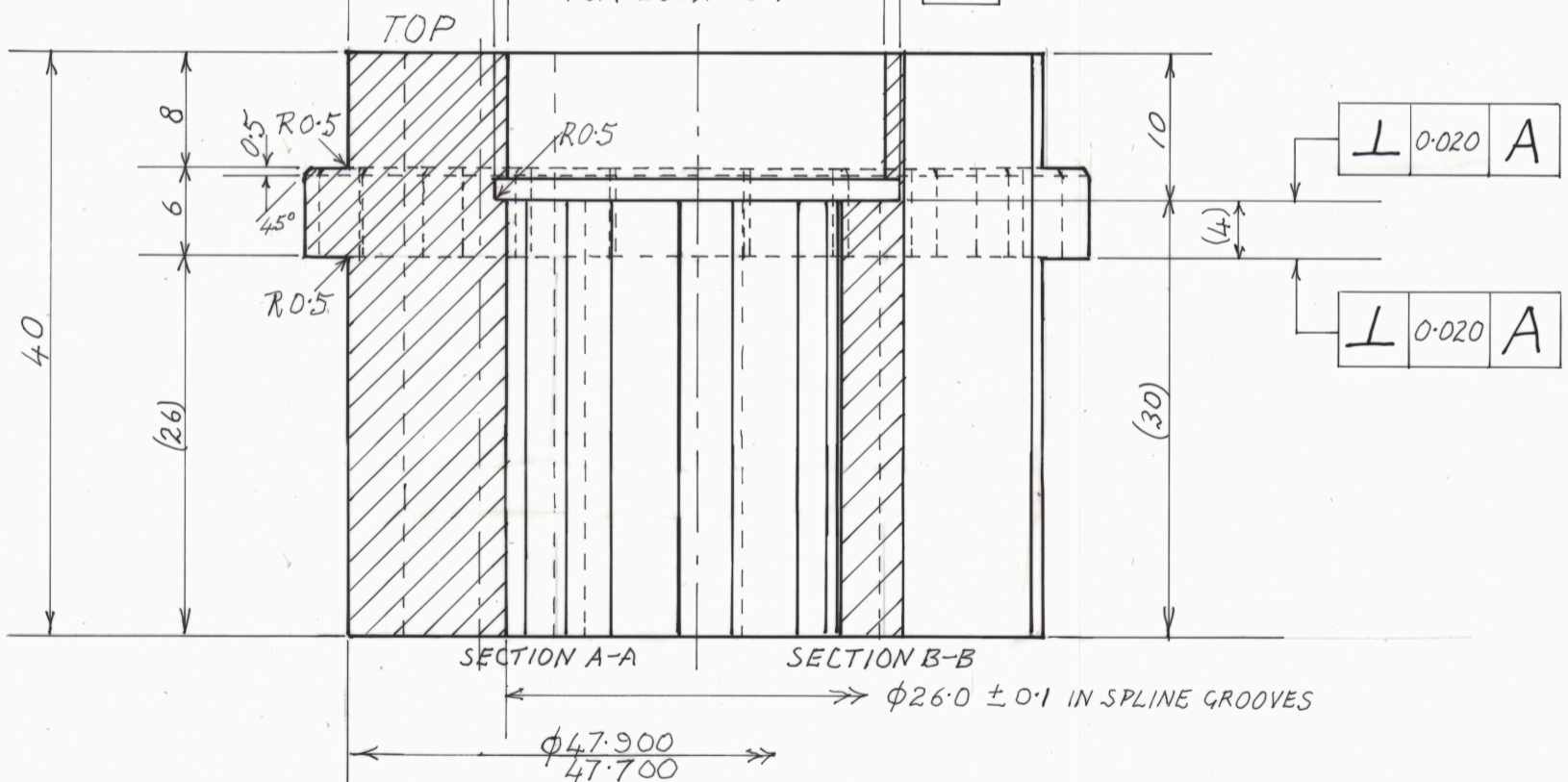

⑧ ASSAB ORVAR SUPREME  
HRC  $46 \pm 2$

DIMENSIONS IN MILLIMETRES  
DO NOT SCALE

TOLERANCES  $\pm 0.3$  UNLESS STATED

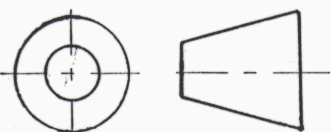

ACN 008 644 273

PATERSON INSTRUMENTS PTY LTD

HPT TESTING MACHINE  
PRESSURE VESSEL ASSEMBLY

STRAIN GAUGE LOAD CELL - DETAIL ⑧

A3

SCALE  
2:1

DATE  
APR 1996  
DEC 1996

DRAWING NO 4404