

ADJUST THICKNESS TO
BALANCE BRIDGE
WITH GAPS 0.3 MM

COUNTERBORE RATES ① & ②
 $\phi 6 \text{ mm} \times 1 \text{ mm}$
 PLATE ① FROM BOTTOM
 ② " " TOP

3 HOLES $\phi 3.2$
 EQUISPACED ON PCD 32
 LINED WITH PUSHFIT
 TEFLON OR SIMILAR
 (NOT TO PROTECT)
 I.D. 2.6/2.7

3 HOLES $\phi 6.0$
 EQUISPACED ON
 PCD 32

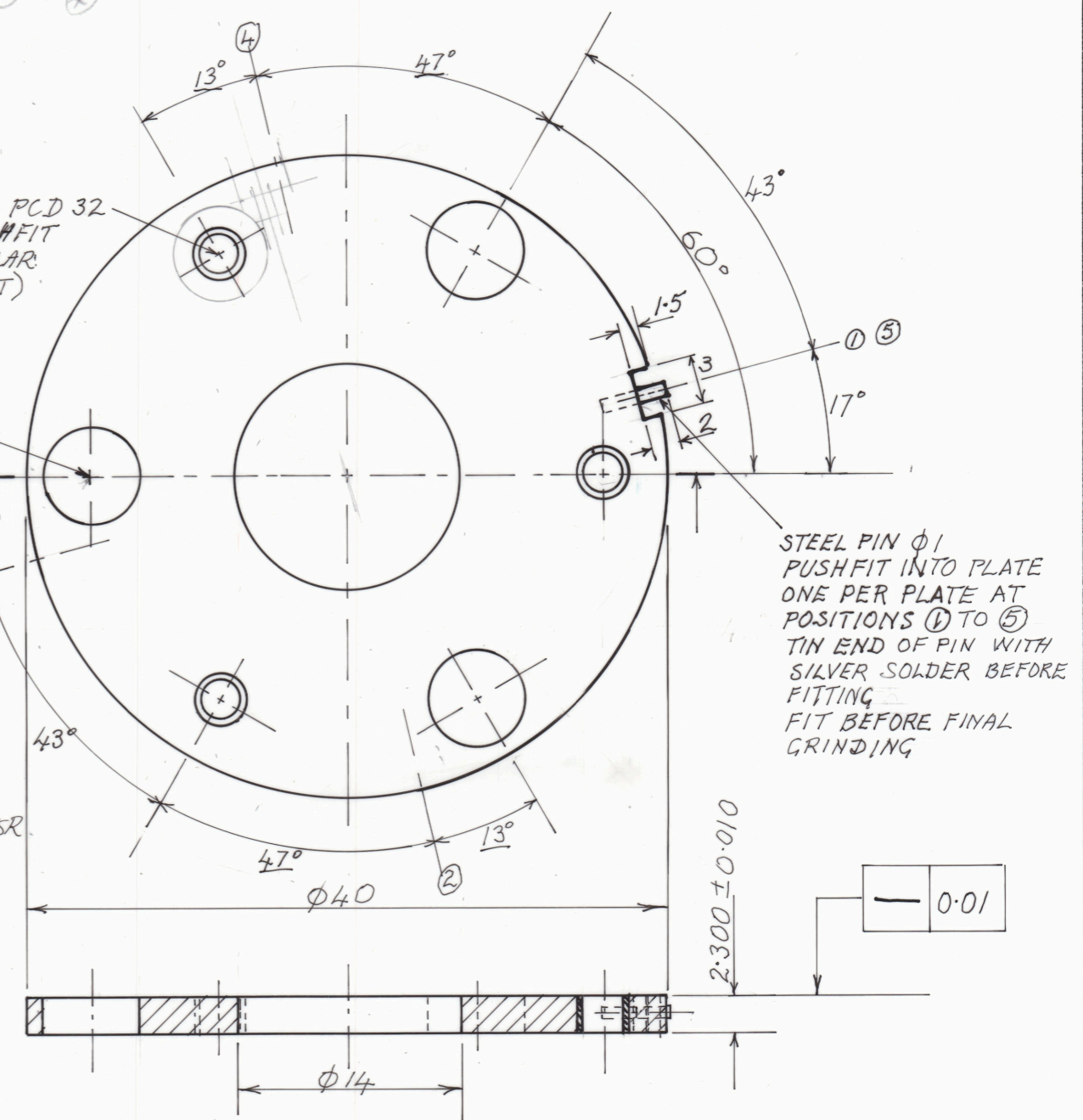

STEEL PIN $\phi 1$
 PUSHFIT INTO PLATE
 ONE PER PLATE AT
 POSITIONS ① TO ⑤
 TIN END OF PIN WITH
 SILVER SOLDER BEFORE
 FITTING
 FIT BEFORE FINAL
 GRINDING

①
 ASSAB STAVAX ESR
 AS RECEIVED

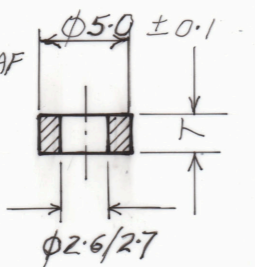
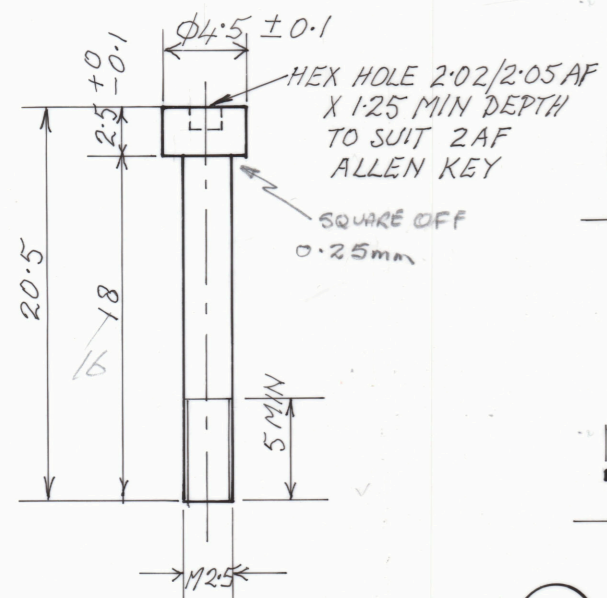

③ ASSAB STAVAX AS RECEIVED
 12 OFF $T = 1.500 \pm 0.010$
 3 OFF $T = 1.000 \pm 0.010$
 3 OFF $T = 4.300 \pm 0.010$

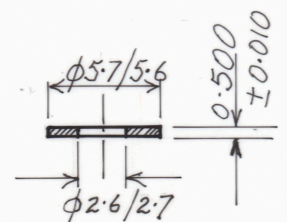

④ PSZ
 30 OFF

② HIGH TENSILE STEEL (E4 EN25)
 6 OFF

DIMENSIONS IN MILLIMETERS -
 DO NOT SCALE

TOLERANCES ± 0.3 UNLESS STATED

PATERSON INSTRUMENTS PTY LTD
 HPT TESTING MACHINE
 AXIAL LOAD CELL
 ARRGT & DETAIL OF CAPACITANCE PLATES

A3	SCALE 2.5:1	DATE JUNE 1994	DRAWING NO 4220B
----	----------------	-------------------	---------------------